

# INSTALLATION MANUAL

10112D/./V

LED  
BUILT IN



DARK  
LIGHT



83mm

230V | COB | CCT V | 12W | IP20 | Aluminium  
Complete with 300mA driver.

90  
CRI

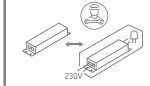

85mm

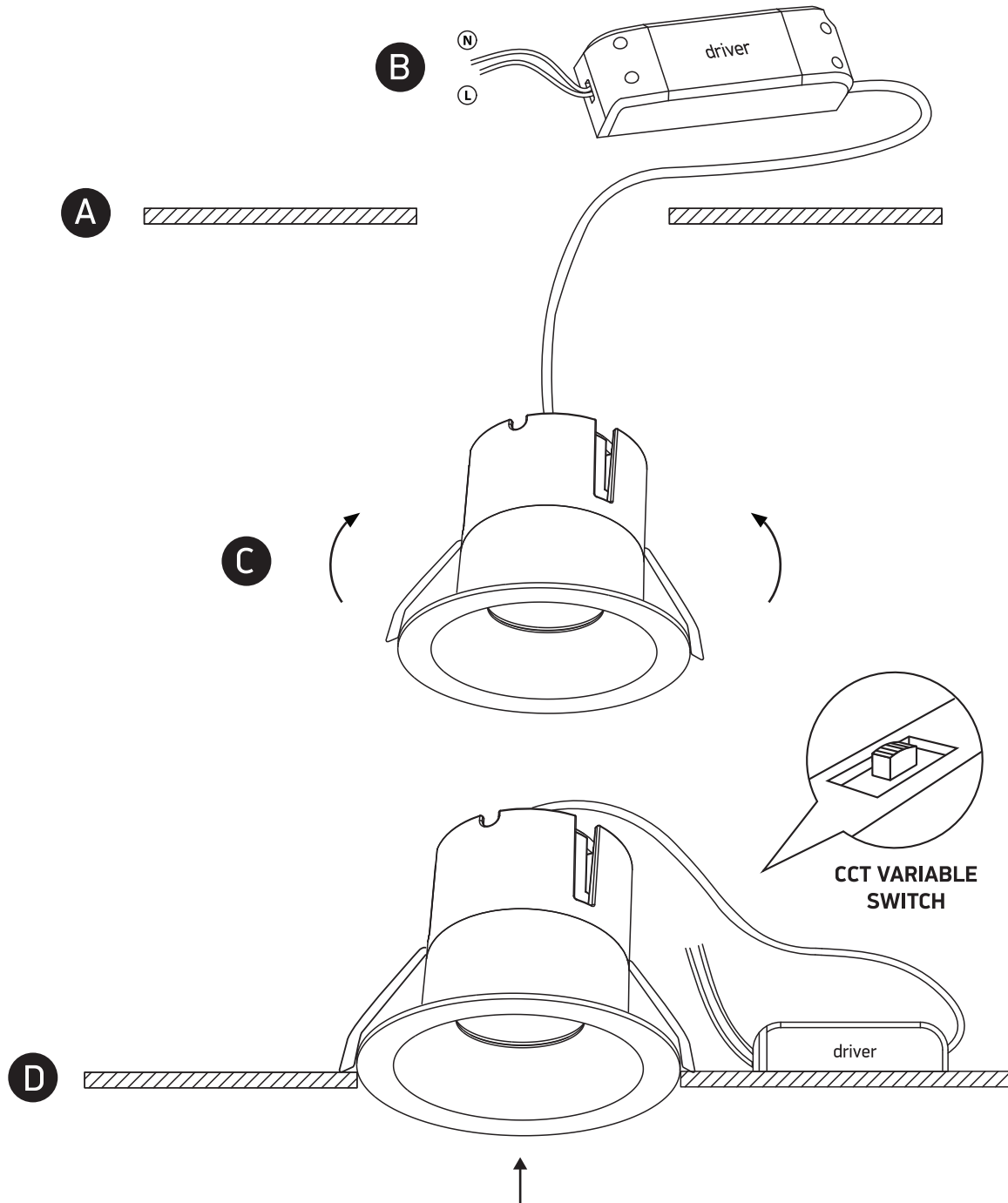

## Warnings:

1. Make sure that the product is installed properly before connecting to electricity.
2. Do not cover the fitting.
3. Maintenance and installation should only be carried out by a professional electrician.

[www.1-light.eu](http://www.1-light.eu)