

INSTALLATION MANUAL

10120Z/./V

LED
BUILT IN



DARK
LIGHT



90
CRI



CE ENEC UK CA



230V | COB | CCT V | 20W | IP20 | Aluminium + plastic reflector

Complete with 500mA driver.

Reflector must be ordered separately. Order code: 050378C.

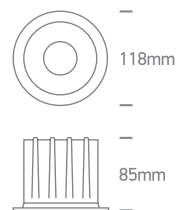

one
LIGHT

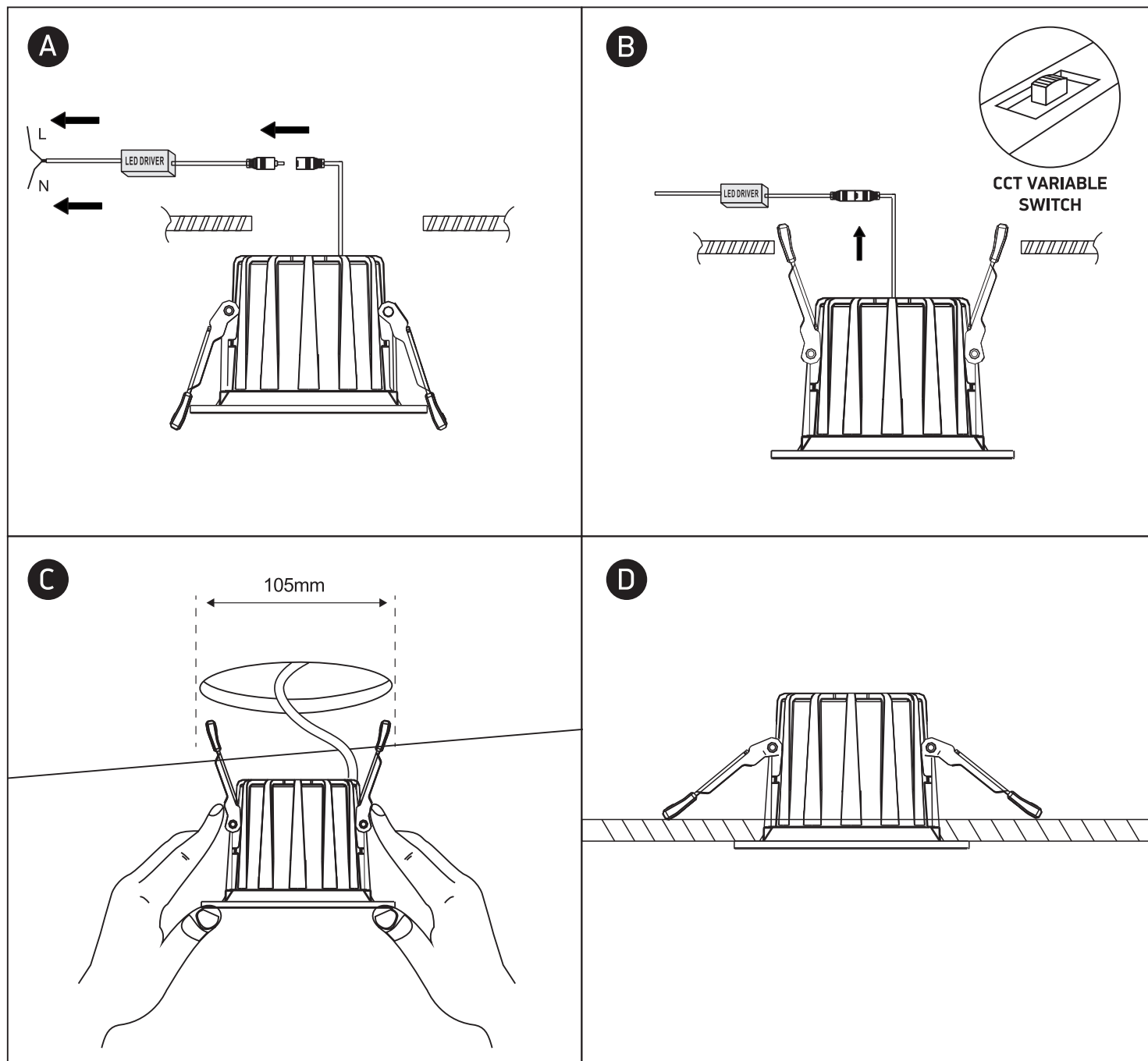

Warnings:

1. Make sure that the product is installed properly before connecting to electricity.
2. Do not cover the fitting.
3. Maintenance and installation should only be carried out by a professional electrician.

www.1-light.eu