

# INSTALLATION MANUAL

10125BX/./V

LED  
BUILT IN



90  
CRI

CE EAC UK

CA

RoHS  
COMPLIANT



230V | SMD | CCT V | 25W | IP65 | Aluminium  
Complete with 650mA driver.

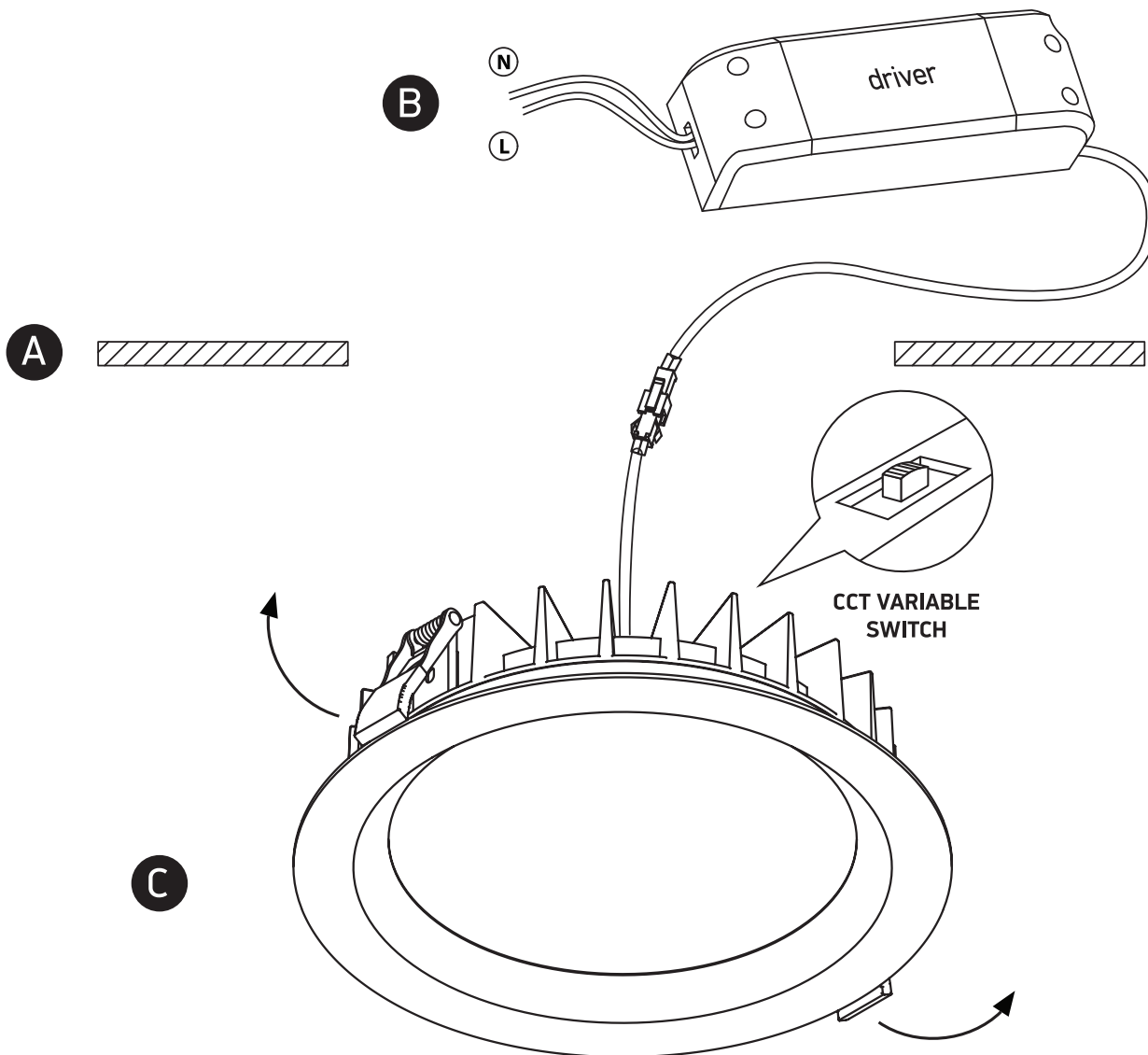
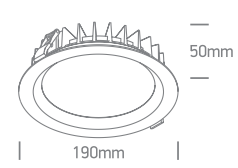
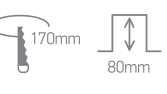
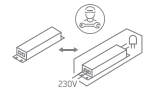

## Warnings:

1. Make sure that the product is installed properly before connecting to electricity.
2. Do not cover the fitting.
3. Maintenance and installation should only be carried out by a professional electrician.