

# INSTALLATION MANUAL

11107FD/./V

**LED**  
BUILT IN



**DARK  
LIGHT**



**CCT V**

**CE ENEC UK**

**RoHS  
COMPLIANT**



**NOT  
DIMMABLE**



95mm



83mm

230V | COB | CCT V | 7W | IP20 | Aluminium  
Complete with 200mA driver.

**90  
CRI**

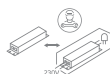

**one**  
LIGHT

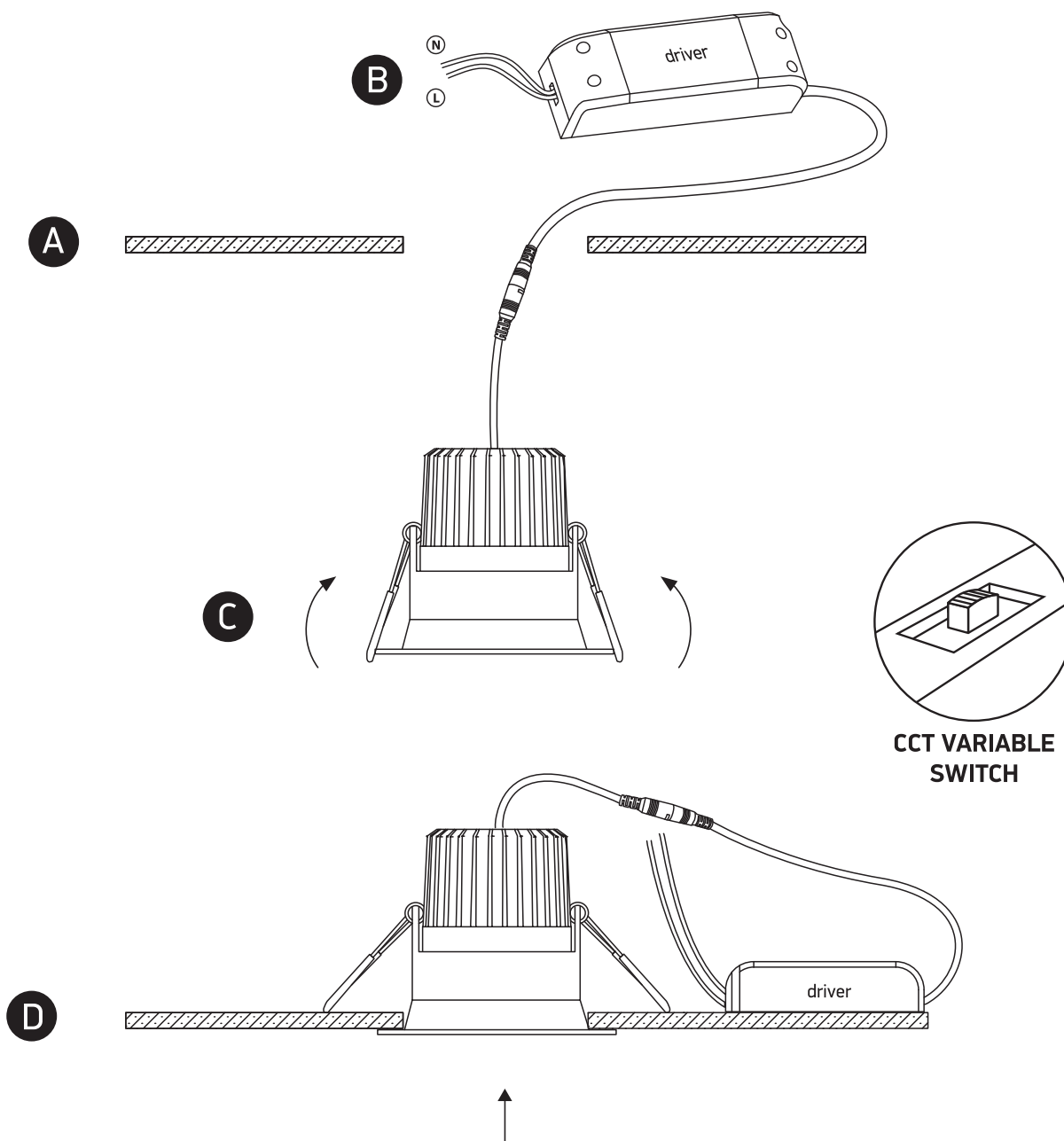

## Warnings:

1. Make sure that the product is installed properly before connecting to electricity.
2. Do not cover the fitting.
3. Maintenance and installation should only be carried out by a professional electrician.