

INSTALLATION MANUAL

12118R

LED
BUILT IN



CE ENEC UKCA

RoHS
COMPLIANT



230V | COB | 18W | IP20 | Aluminium
Complete with 450mA driver.

90
CRI

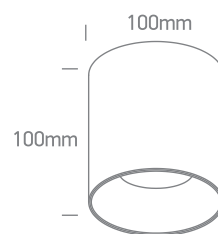
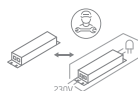

one
LIGHT

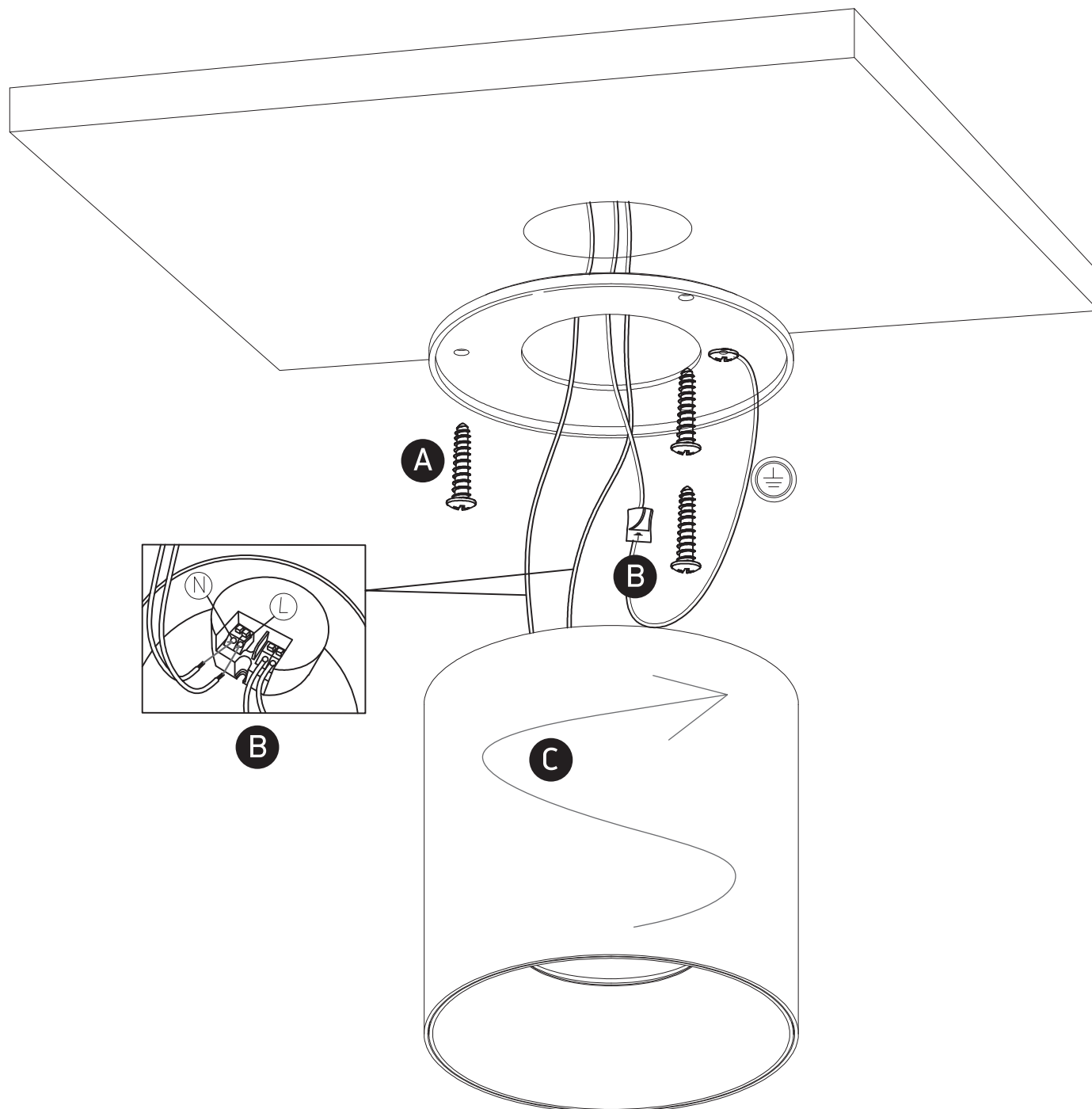

Warnings:

1. Make sure that the product is installed properly before connecting to electricity.
2. Do not cover the fitting.
3. Maintenance and installation should only be carried out by a professional electrician.

www.1-light.eu