

INSTALLATION MANUAL

22004M

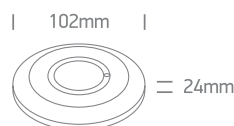

230V | 250W | IP20 | Surface microwave sensor

Time Delay: 10sec ± 3sec to 12min ± 1 min (adjustable).
Ambient Light: <3-2000lux (adjustable).
Installation height: 2-6m
Cable entry is from the back.

one
LIGHT

INSTALLATION

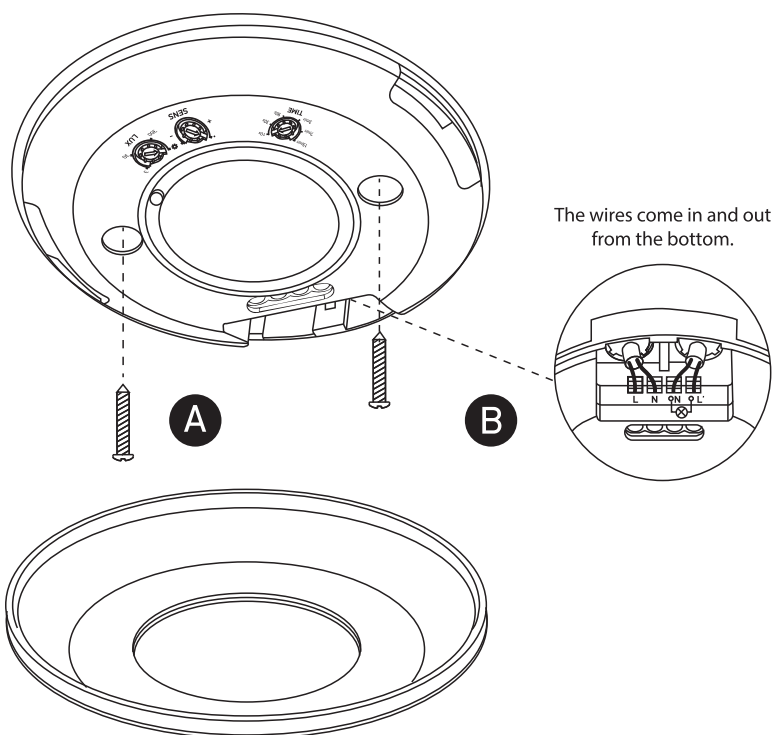

WIRING DIAGRAM

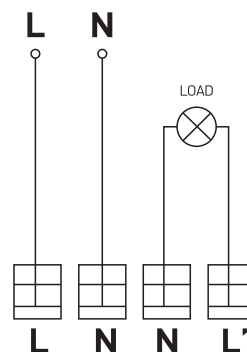

WIRING DIAGRAM WITH BYPASS SWITCH

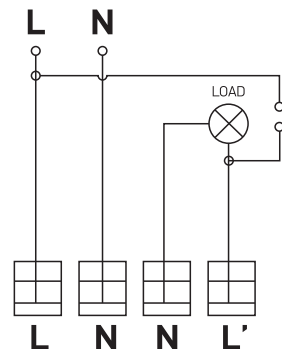

TEST:

- Turn the TIME knob anti-clockwise to the minimum (10s). Turn the SENS knob clockwise to the maximum (+). Turn the LUX knob clockwise to the maximum. ☀
- When you switch on the power, the light will be on at once. And 10sec±3sec later the light will turn off.
- Turn LUX knob anti-clockwise to the minimum (3). If the ambient light is less than 3LUX (darkness), the sensor will work when it detects motion.

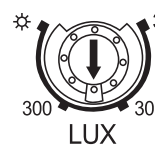
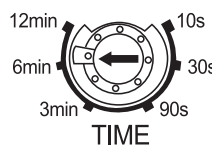

Note:

When testing in daylight, please turn LUX knob to ☀ position, otherwise the sensor will not work!

Warnings:

1. Make sure that the product is installed properly before connecting to electricity.
2. Do not cover the fitting.
3. Maintenance and installation should only be carried out by a professional electrician.

www.1-light.eu