

INSTALLATION MANUAL

38100A/./V

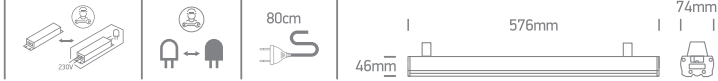

230V | SMD | CCT V | 20W PV | IP20 | Aluminium
 Complete with PV driver / Can be connected in line.
 Optional suspension kit 050012.



A SURFACE INSTALLATION

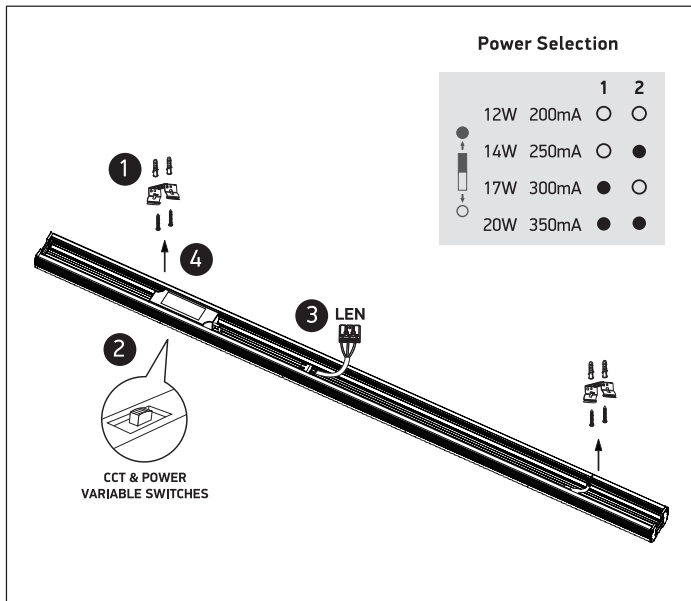

B SUSPENDED INSTALLATION

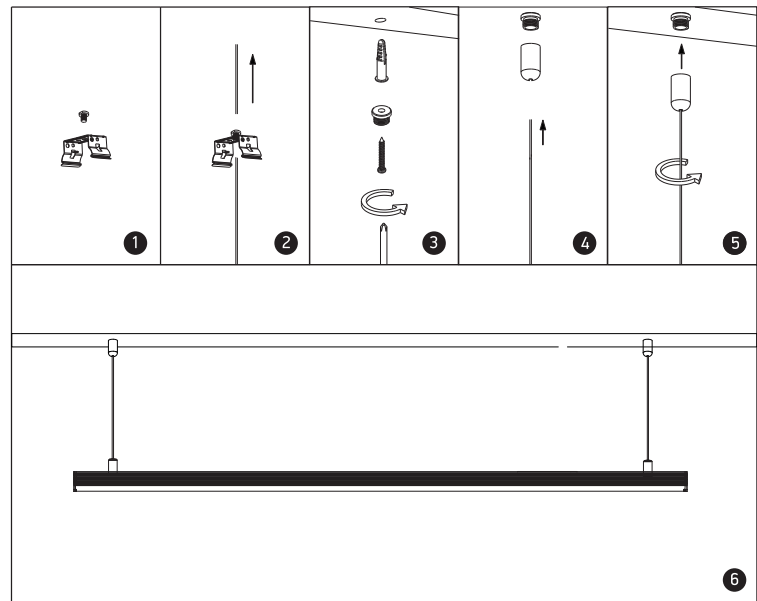

C CONNECTION

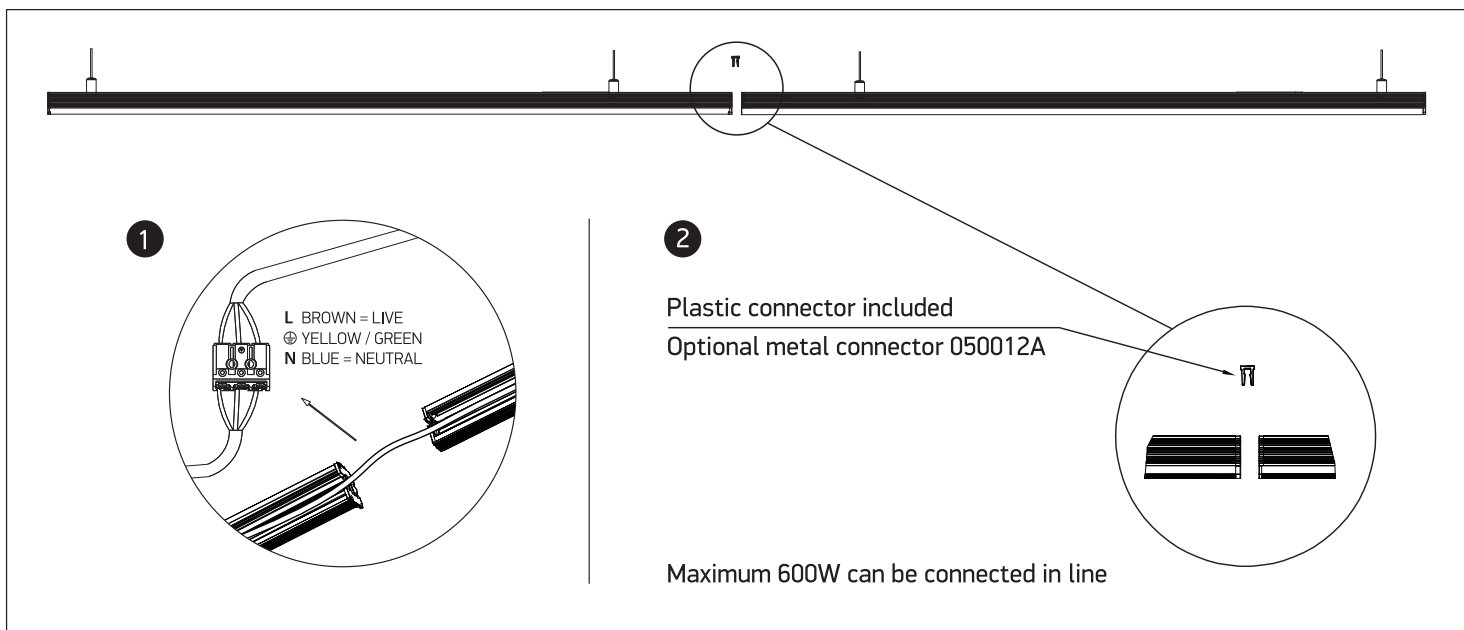

Warnings:

1. Make sure that the product is installed properly before connecting to electricity.
2. Do not cover the fitting.
3. Maintenance and installation should only be carried out by a professional electrician.