

# INSTALLATION MANUAL

38100B/./V



230V | SMD | CCT V | 40W PV | IP20 | Aluminium  
 Complete with PV driver / Can be connected in line.  
 Optional suspension kit 050012.



## A SURFACE INSTALLATION

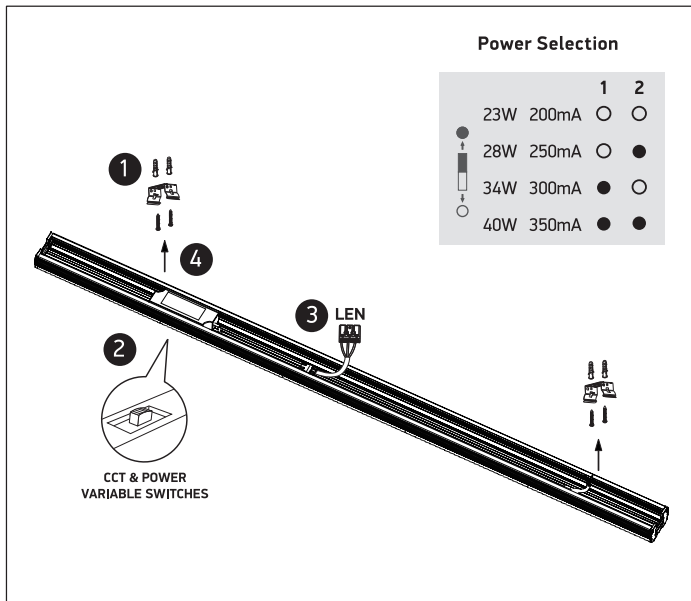

## B SUSPENDED INSTALLATION

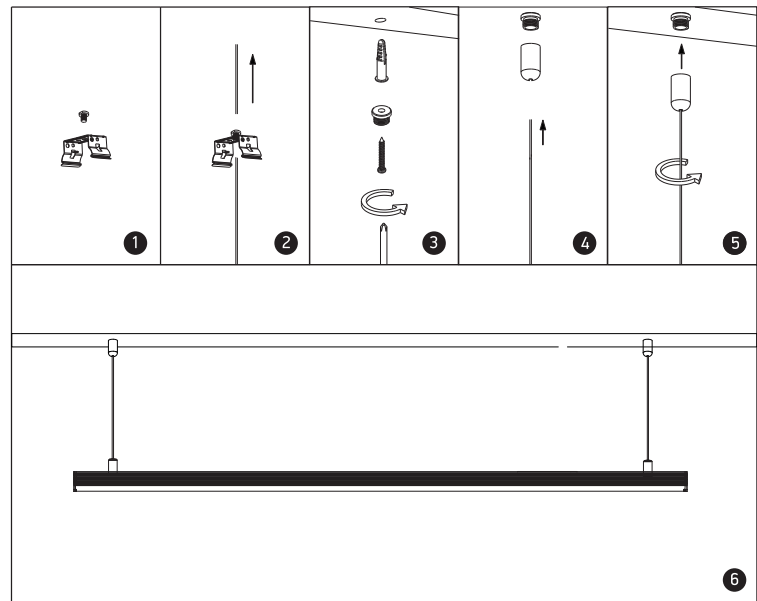

## C CONNECTION

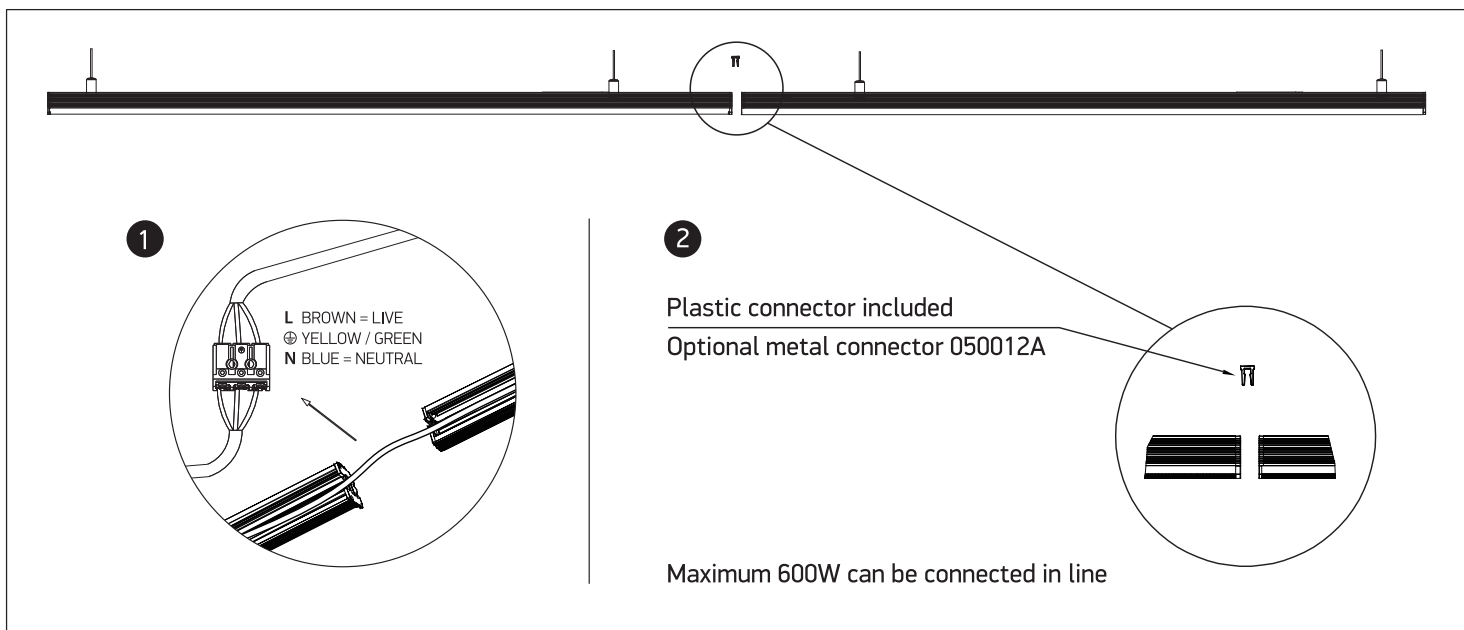

### Warnings:

1. Make sure that the product is installed properly before connecting to electricity.
2. Do not cover the fitting.
3. Maintenance and installation should only be carried out by a professional electrician.