

# INSTALLATION MANUAL

42006BX

**LED**   **90%** NO LOAD  
EFFICIENCY **<0.5W**

**CE ENEC UK CA**   

230V | 250W | 48V | IP20

MINI	MIDI	MAXI
✓	✓	✓

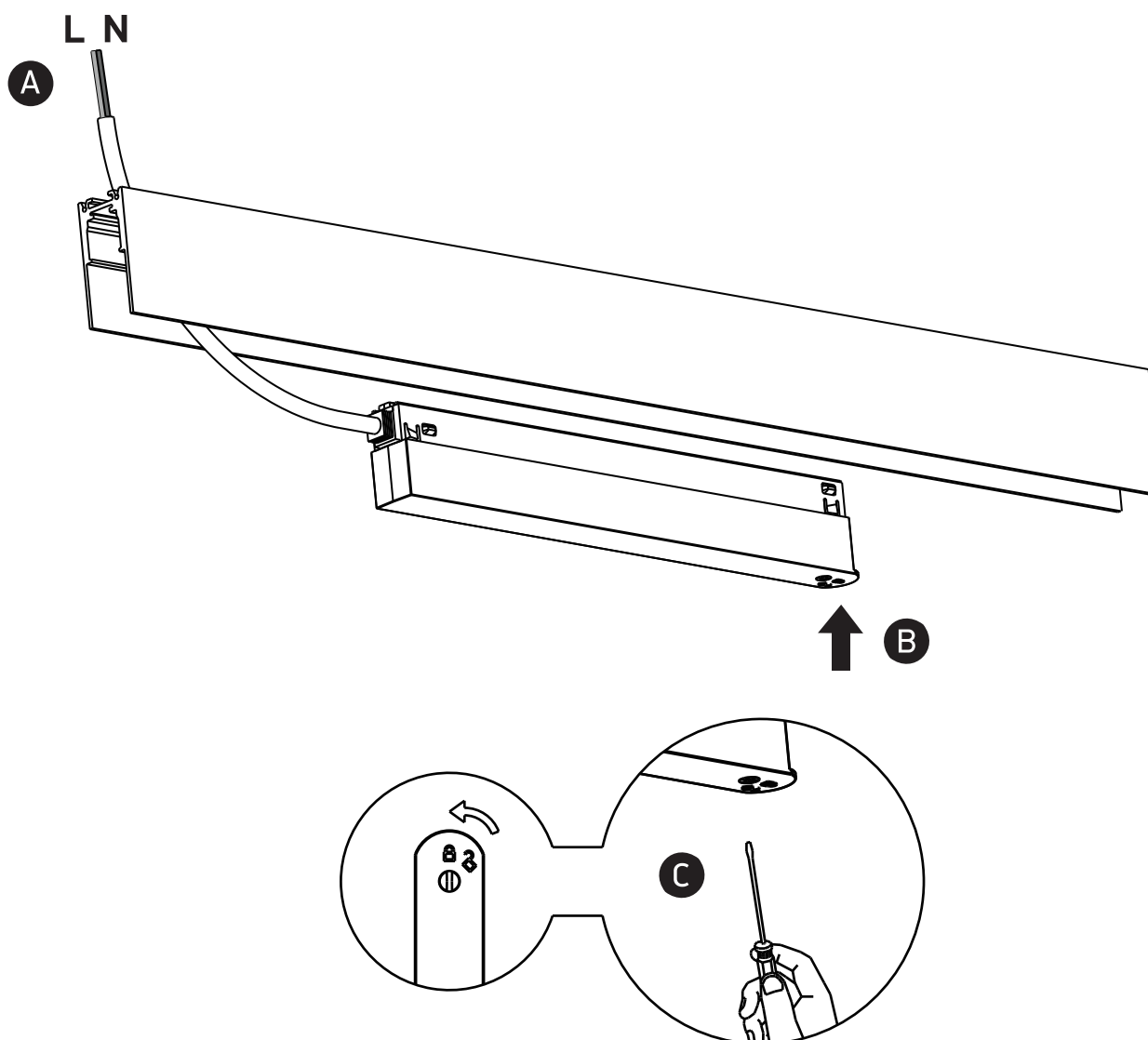
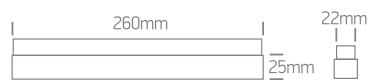

## Warnings:

1. Make sure that the product is installed properly before connecting to electricity.
2. Do not cover the fitting.
3. Maintenance and installation should only be carried out by a professional electrician.