

INSTALLATION MANUAL

42144L/./V

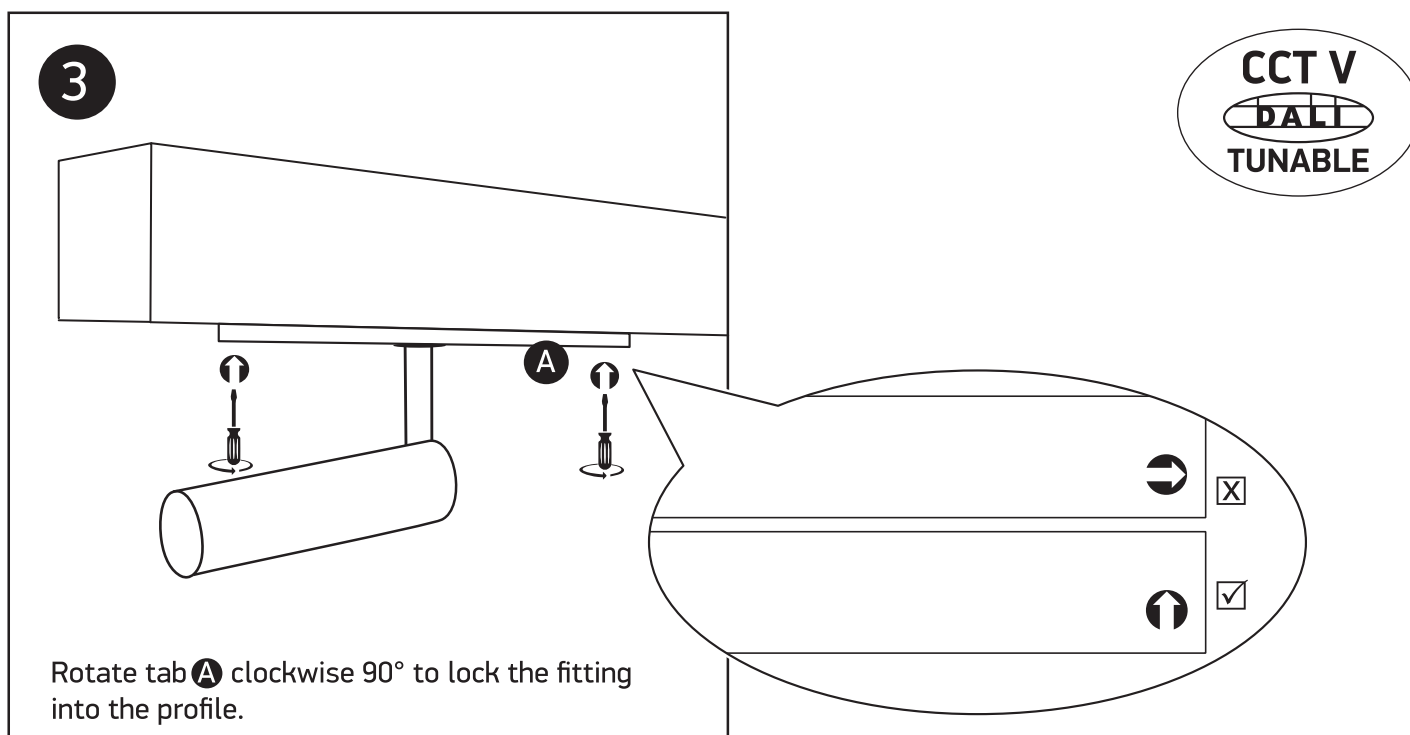

10W | LED | CCT V | DT8 | 48V | IP20 | Aluminium

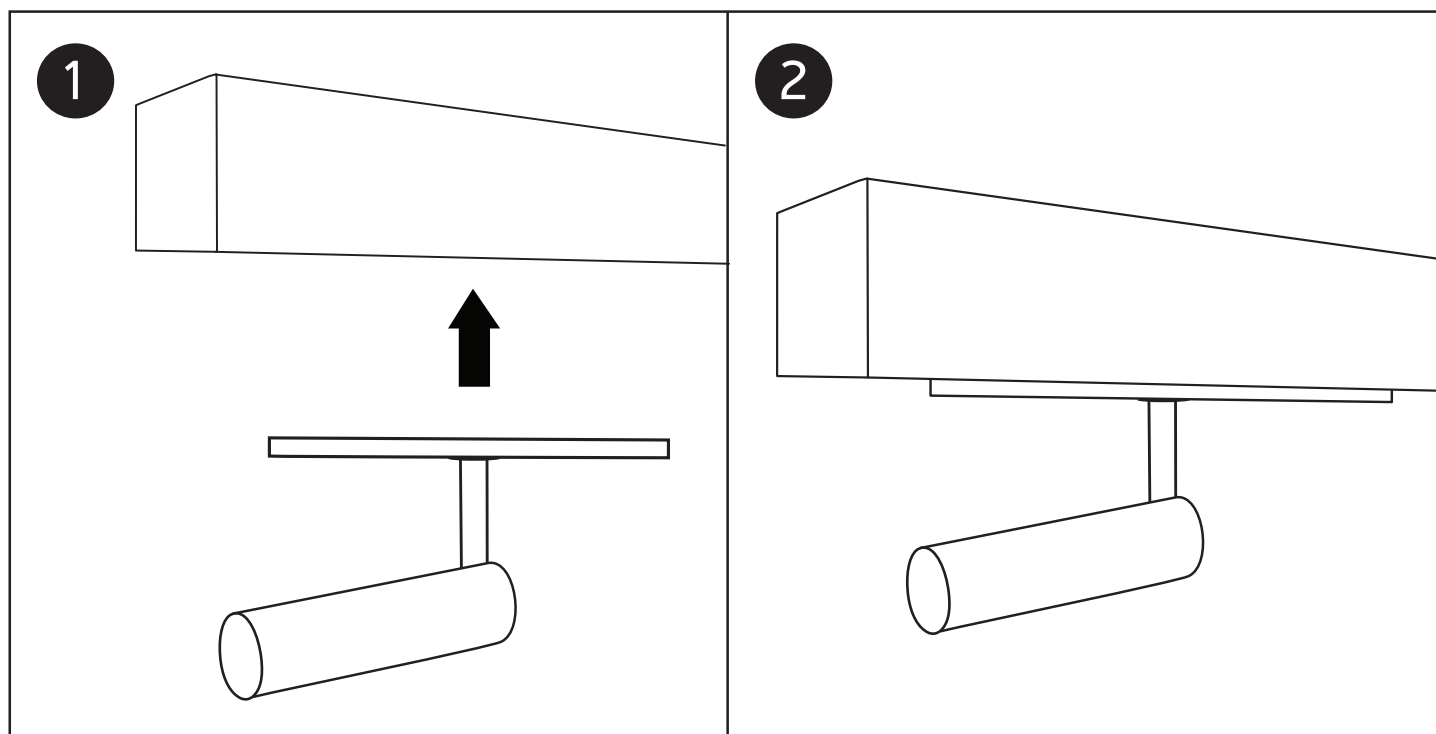
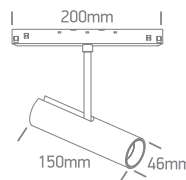

Rotate tab **A** clockwise 90° to lock the fitting into the profile.

Warnings:

1. Make sure that the product is installed properly before connecting to electricity.
2. Do not cover the fitting.
3. Maintenance and installation should only be carried out by a professional electrician.

www.1-light.eu