

INSTALLATION MANUAL

50115UV/./V

LED
BUILT IN



UGR19



230V | SMD LED | CCT V | 15W | IP44 | Aluminium
Complete with 350mA driver.

90
CRI

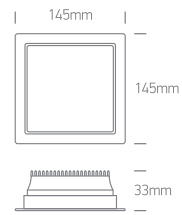

one
LIGHT

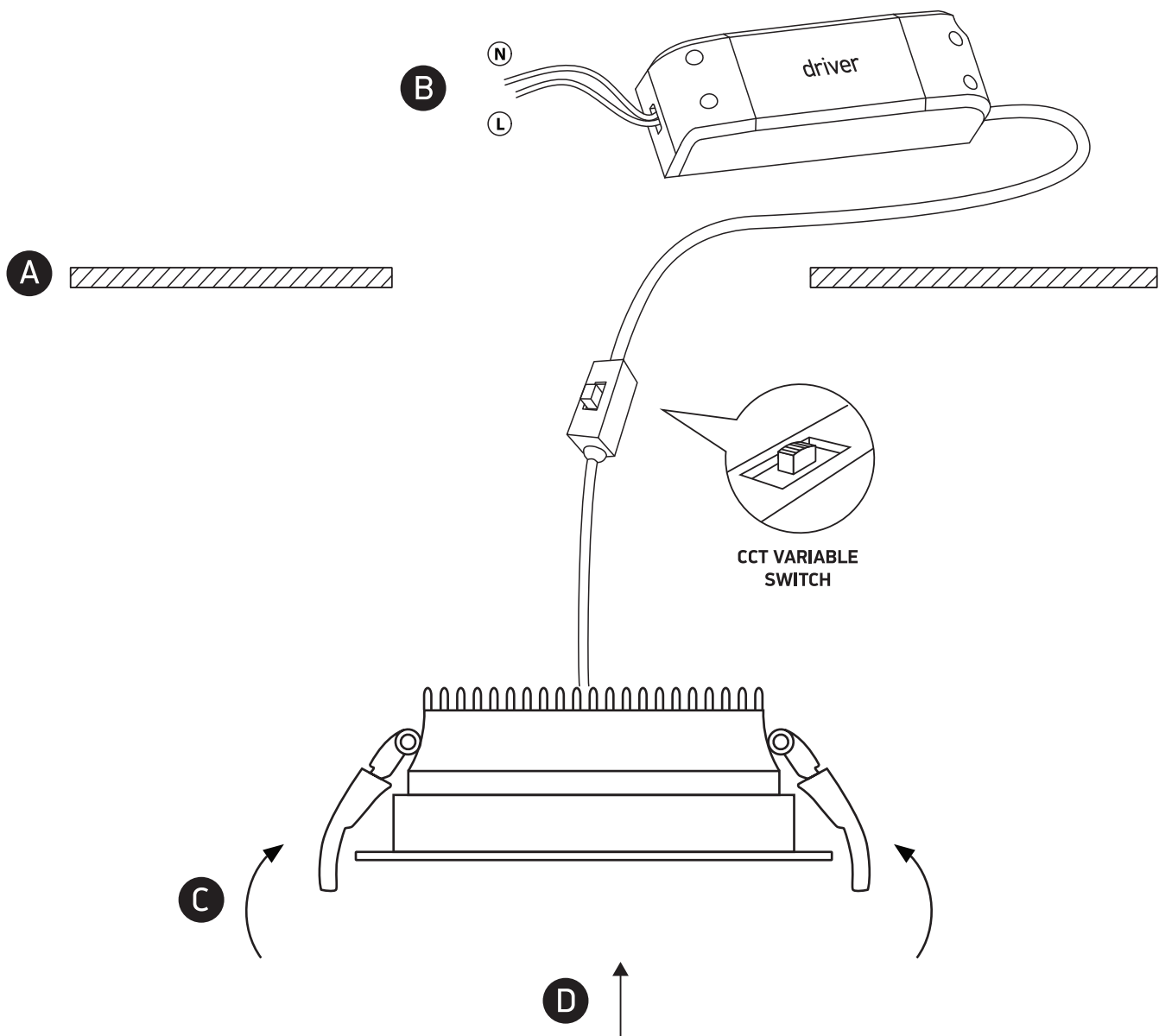

Warnings:

1. Make sure that the product is installed properly before connecting to electricity.
2. Do not cover the fitting.
3. Maintenance and installation should only be carried out by a professional electrician.

www.1-light.eu