

INSTALLATION MANUAL

62026A/V, 62026B/V, 62026C/V, 62026D/V

LED
BUILT IN



80
CRI



CE

EAC

UK
CA

RoHS
COMPLIANT



Complete with driver.

62026A/V

230V | SMD | CCT V | 15W | IP20
Metal + PMMA

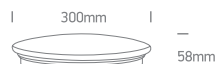

62026B/V

230V | SMD | CCT V | 24W | IP20
Metal + PMMA



62026C/V

230V | SMD | CCT V | 30W | IP20
Metal + PMMA



62026D/V

230V | SMD | CCT V | 50W | IP20
Metal + PMMA



one
LIGHT

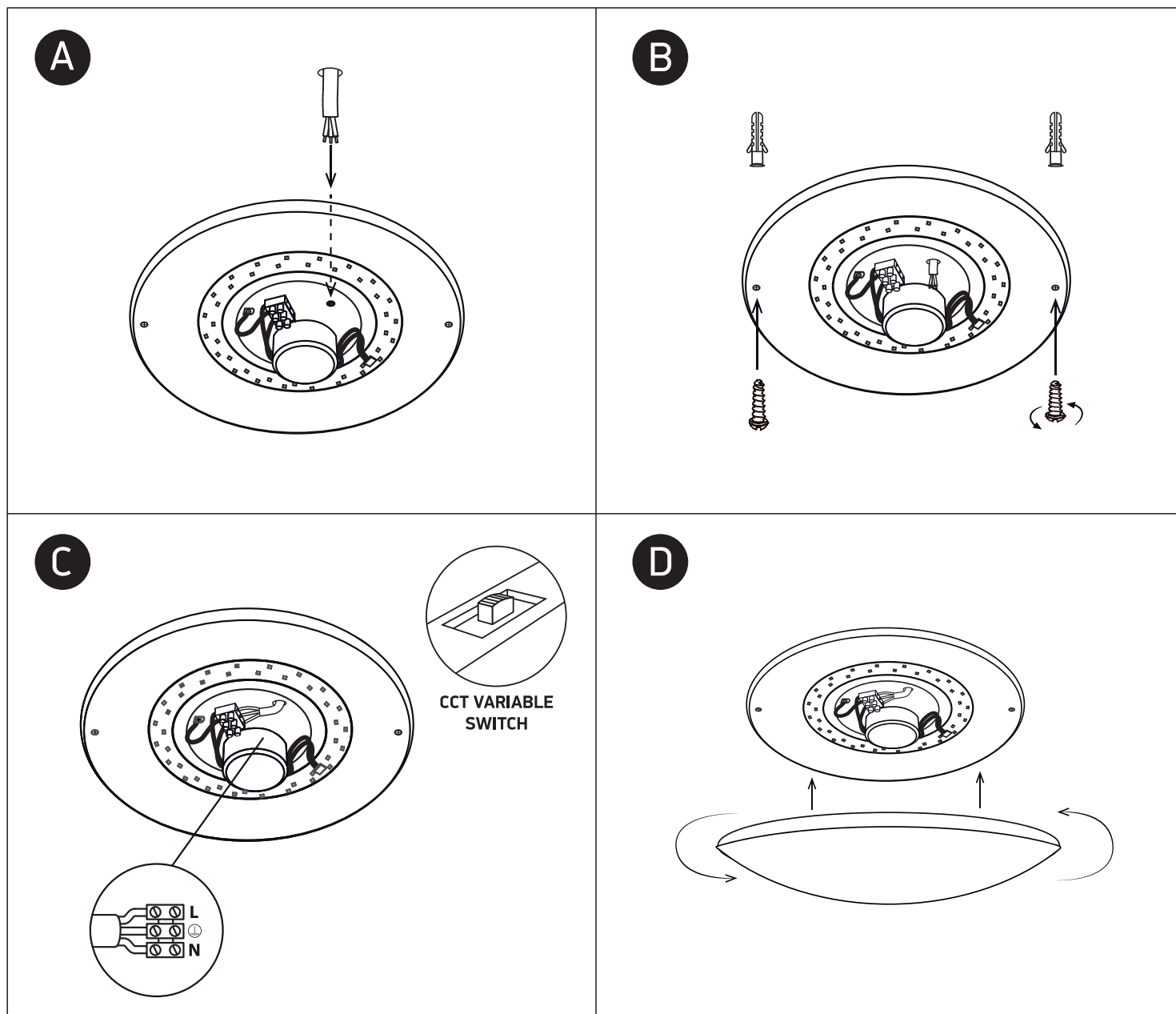

Warnings:

1. Fix the base on the ceiling.
2. Make sure that the product is installed properly before connecting to electricity.
3. Connect the AC power cable to the driver's cable as shown in the above diagram.
4. Do not cover the fitting.
5. Maintenance and installation should only be carried out by a professional electrician.