

# INSTALLATION MANUAL

62132N

LED  
BUILT IN



80  
CRI

CE ENEC UK CA

ROHS  
COMPLIANT



NOT  
DIMMABLE

230V | SMD 2835 | 32W | IP20 | Aluminium

Complete with 800mA driver

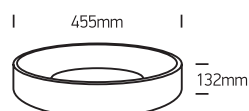
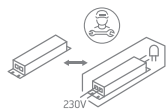

one  
LIGHT

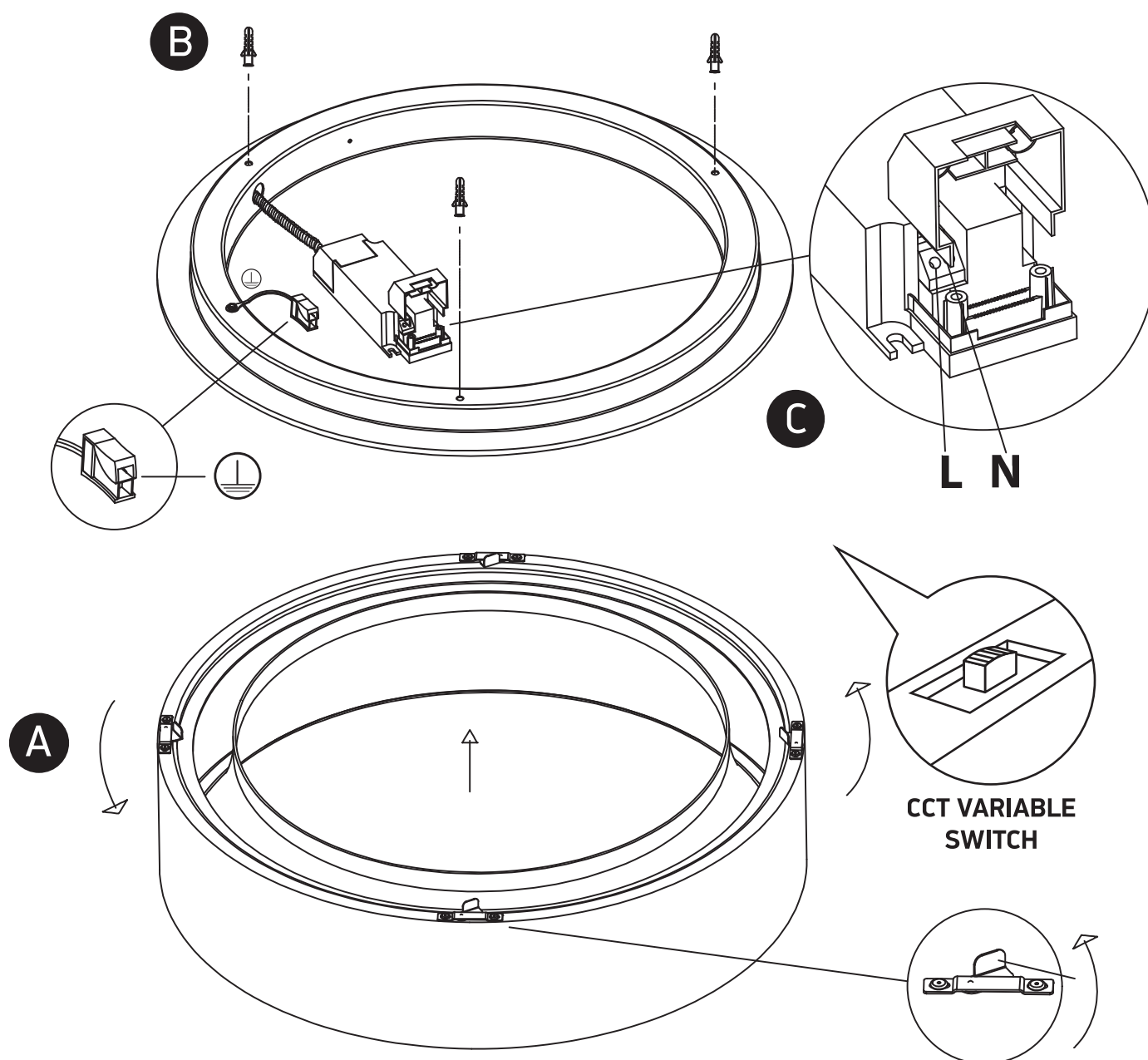

## Warnings:

1. Fix the base on the ceiling.
2. Make sure that the product is installed properly before connecting to electricity.
3. Connect the AC power cable to the driver's cable as shown in the above diagram.
4. Do not cover the fitting.
5. Maintenance and installation should only be carried out by a professional electrician.