

# INSTALLATION MANUAL

6300

**LED**  
BUILT IN



**DC 25W** MOTOR | **6** SPEED | **32W** LED | **3500** LUMEN

230V | LED 32W | DC MOTOR 25W | Metal body | PC blades | Rod mounted  
 · Maximum air flow rate 71m<sup>3</sup>/min  
 · Service value 2,8/W  
 · Standby power consumption 0,5W  
 · Fan sound power level 40dB(A)  
 · Maximum air velocity 2,3 m/sec.  
 · Max RPM 255

LIGHT ON/OFF SWITCH | 85 CRI

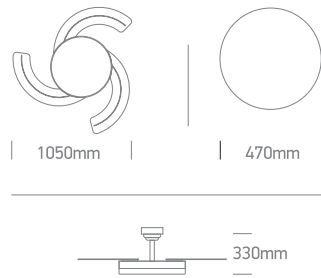

<p><b>1</b></p> <p><b>1a</b></p> <p>Install ceiling bracket.</p>	<p><b>2</b></p> <p>Remove the R clip from the pin. Then remove the pin from the rod.</p>	<p><b>3</b></p> <p><b>A</b> Place the parts on the rod. <b>B</b> Pass wires through rod.</p>	<p><b>4</b></p> <p><b>A</b> Put the rod into the motor and install the pin and R clip. <b>B</b> Tighten all the nuts and screws.</p>
<p><b>5</b></p> <p>Hang the fan onto the ceiling bracket.</p>	<p><b>6</b></p> <p>Place the receiver on the hanger bracket.</p>	<p><b>7</b></p> <p>Connect wires.</p>	
<p><b>8</b></p>		<p><b>9</b></p> <p>Install the diffuser.</p>	

**Warnings:**

1. Make sure that the product is installed properly before connecting to electricity.
2. Maintenance and installation should only be carried out by a professional electrician.

# INSTALLATION MANUAL

6300

## REMOTE CONTROL

Requires 2xAAA batteries. Remove batteries if not used for long period of time.

- ❶ LED indicator
- ❷ ON/OFF
- ❸ Mute sound
- ❹ Warm white LED
- ❺ Cool white LED
- ❻ Daylight LED
- ❼ Fan OFF
- ❽ Fan speeds: To turn fan ON 1(lowest) to 6 (highest)
- ❾ LED light ON / OFF
- ❿ LED dimmer
- ⓫ Breeze: Fan speeds automatic cycle between 1 to 6
- ⓬ Vacation mode: Switch on the light kit  
5 minutes each 2 hours
- ⓭ Reverse function for winter and summer
- ⓮ Timer: Fan stops after 2h/4h/8h

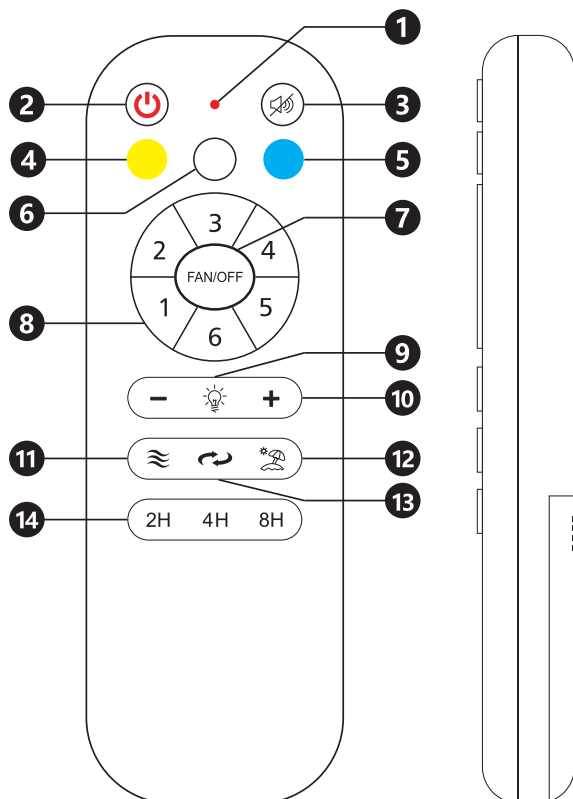

## PACKAGE CONTENTS

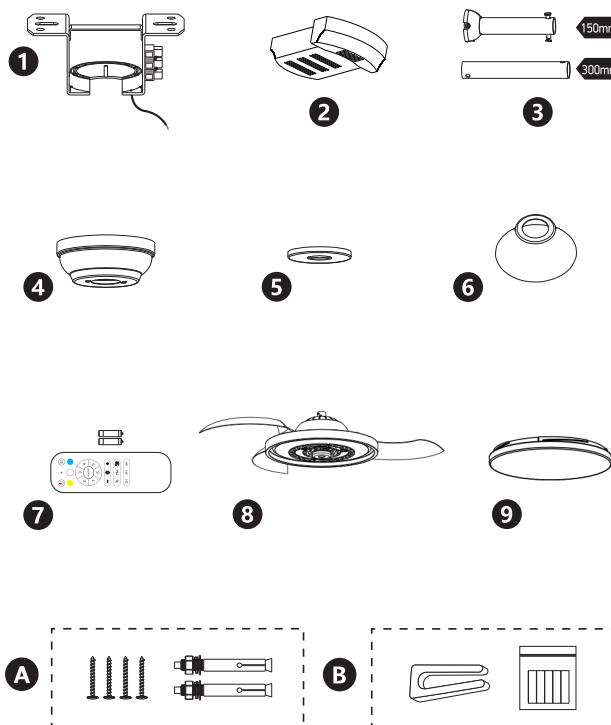

- ❶ Hanger bracket
- ❷ Receiver
- ❸ Rod assembly
- ❹ Canopy
- ❺ Canopy cover
- ❻ Cover
- ❼ Remote control + holder  
+2 mounting screws  
+1.5V (AAA)x2 batteries
- ❽ Fan motor / LED lightkit
- ❾ Diffuser
- Ⓐ Mounting hardware
- Ⓑ Blade balancing kit

**NOTE:** When switching mains ON, light automatically turns on.

### Warnings:

1. Make sure that the product is installed properly before connecting to electricity.
2. Maintenance and installation should only be carried out by a professional electrician.