

INSTALLATION MANUAL

6322C/./V



DC MOTOR 29W MOTOR 6 SPEED WINTER REVERSE MOTOR REMOTE CONTROL LIGHT ON/OFF SWITCH 15W LED 1400 LUMEN

230V | LED 15W | DC Motor 29W | IP20 | Metal body | ABS blades | Ceiling mounted

· Maximum air flow rate 133m³/min
· Service value 4,5/W
· Standby power consumption 0,5W

· Fan sound power level 45dB(A)
· Maximum air velocity 1,6 m/sec.
· Max RPM 205

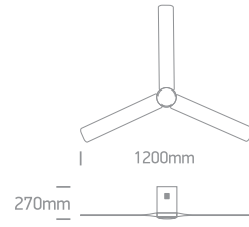

<p>1</p> <p>Remove ceiling brackets.</p>	<p>2</p> <p>Install the fan blades and tighten screws.</p>	
<p>3</p> <p>A. Connect cable. B. Install LED fitting.</p>	<p>4</p> <p>Install ceiling bracket.</p>	<p>5</p> <p>Connect wires</p>
<p>6</p>	<p>7</p> <p>X4</p>	<p>8</p>

Warnings:

1. Make sure that the product is installed properly before connecting to electricity.
2. Maintenance and installation should only be carried out by a professional electrician.

INSTALLATION MANUAL

6322C/./V

REMOTE CONTROL

Requires 2xAAA batteries. Remove batteries if not used for long period of time.

- ① LED indicator
- ② ON/OFF
- ③ Mute sound
- ④ Warm white LED
- ⑤ Cool white LED
- ⑥ Daylight LED
- ⑦ Fan OFF
- ⑧ Fan speeds: To turn fan ON 1(lowest) to 6 (highest)
- ⑨ LED light ON / OFF
- ⑩ LED dimmer
- ⑪ Breeze: Fan speeds automatic cycle between 1 to 6
- ⑫ Vacation mode: Switch on the light kit
5 minutes each 2 hours
- ⑬ Reverse function for winter and summer
- ⑭ Timer: Fan stops after 2h/4h/8h

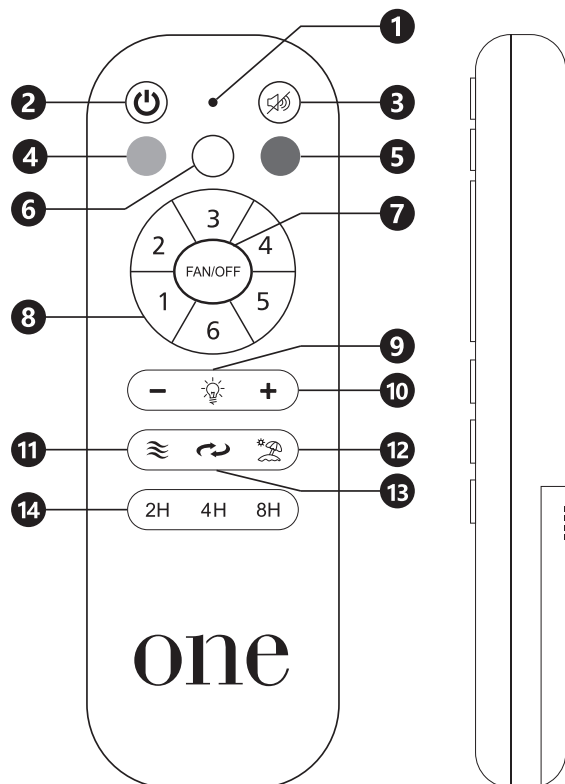

NOTE: To pair a remote to a receiver turn ON the power supply to the fan and press the ON/OFF and MUTE keys on the remote for 3 to 5 seconds. You will hear a beep.

PACKAGE CONTENTS

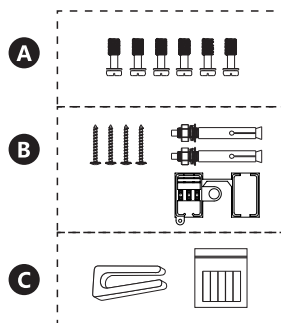
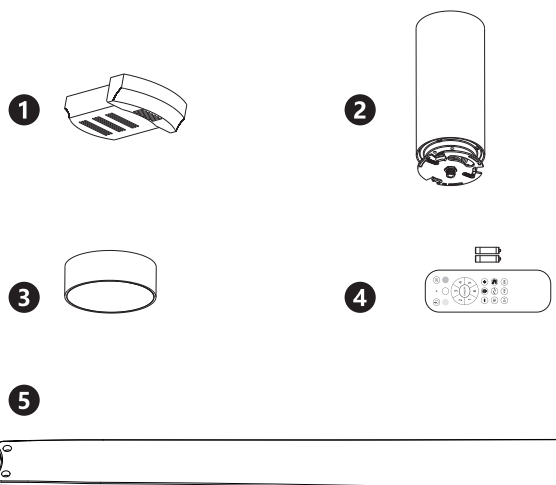

- ① Receiver
- ② Fan motor
- ③ 22W LED
- ④ Remote control + holder
+2 mounting screws
+1.5V (AAA)x2 batteries
- ⑤ Fan blade (3 pcs)
- A Screws for blades
- B Mounting hardware
- C Blade balancing kit

NOTE: When switching mains ON, light automatically turns on.

Warnings:

1. Make sure that the product is installed properly before connecting to electricity.
2. Maintenance and installation should only be carried out by a professional electrician.