

INSTALLATION MANUAL

65105E



DARK
LIGHT



CE EAC UK

CA

RoHS
COMPLIANT



100-240V | MR16 | 10W | GU10 | IP20 | Aluminium
Complete with reflectors.

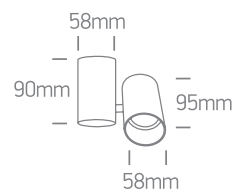

one
LIGHT

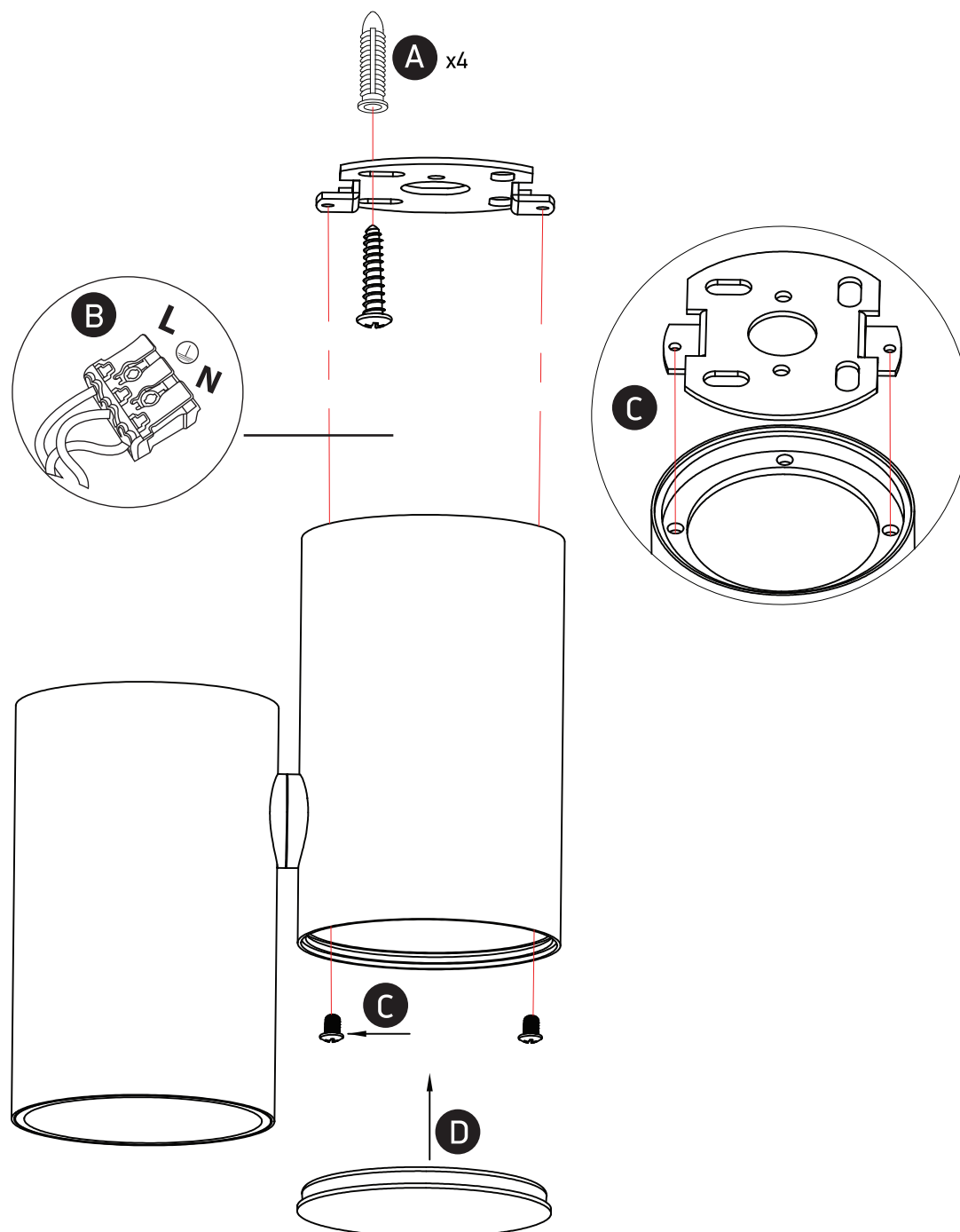

Warnings:

1. Make sure that the product is installed properly before connecting to electricity.
2. Do not cover the fitting.
3. Maintenance and installation should only be carried out by a professional electrician.

www.1-light.eu