

INSTALLATION MANUAL

67363A

LED
BUILT IN



CE ENEC UK CA

RoHS
COMPLIANT



NOT
DIMMABLE

230V | SMD LED | 30W | IP54 | Die cast
Complete with 700mA driver.

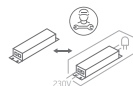

80
CRI

300x300mm

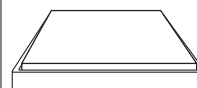

49mm

one
LIGHT

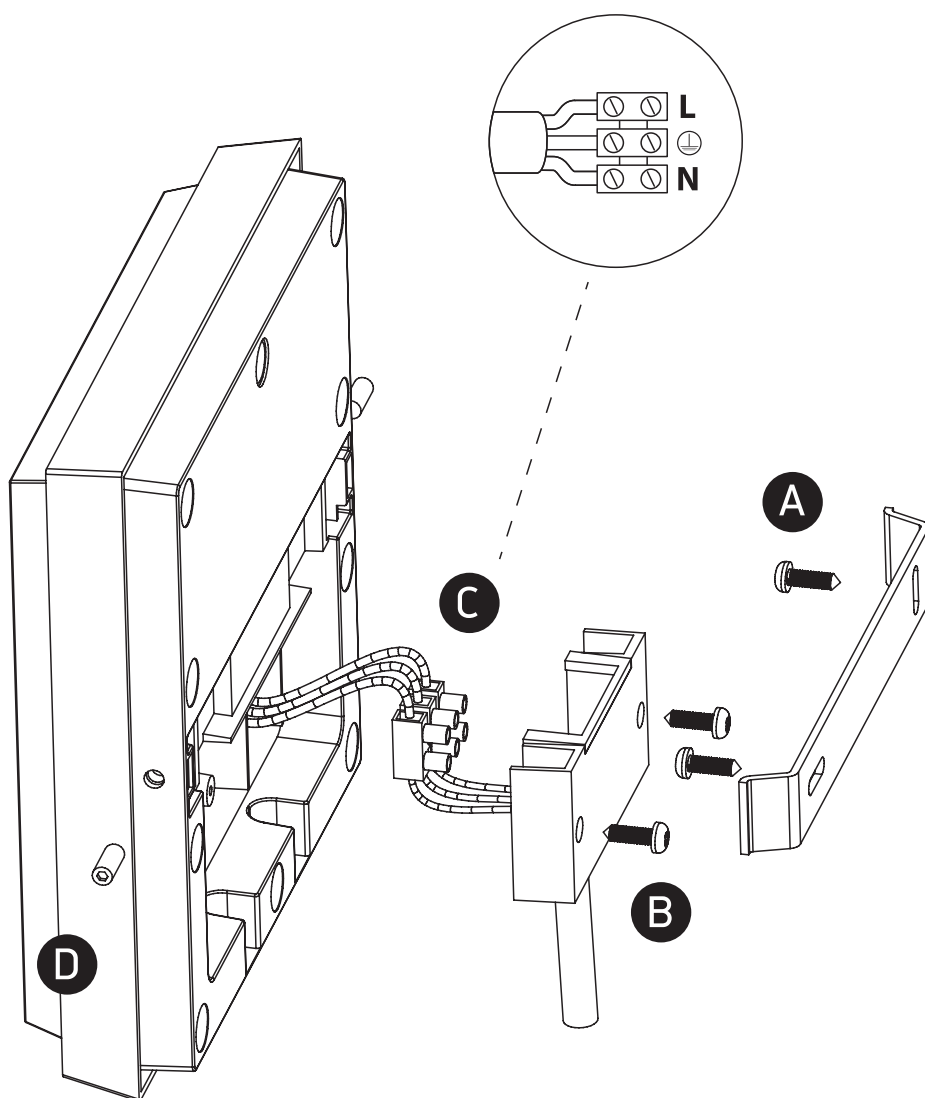

Warnings:

1. Make sure that the product is installed properly before connecting to electricity.
2. Do not cover the fitting.
3. Maintenance and installation should only be carried out by a professional electrician.