

INSTALLATION MANUAL

67366E

ecolight



80
CRI



230V | SMD 2835 | 12W | IP54 | Emergency 3Hrs Maintained | PC

Complete with driver

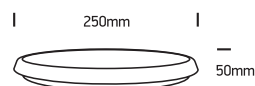

one
LIGHT

A

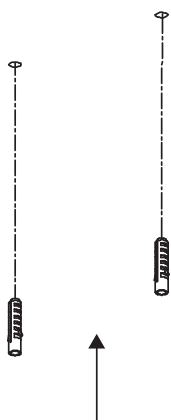

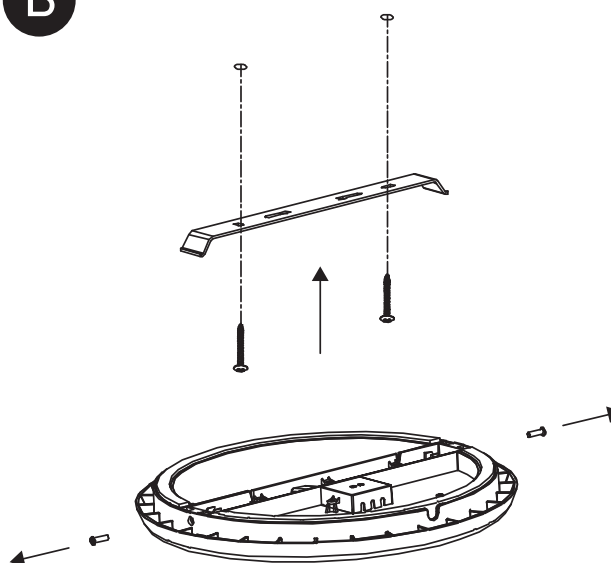

B

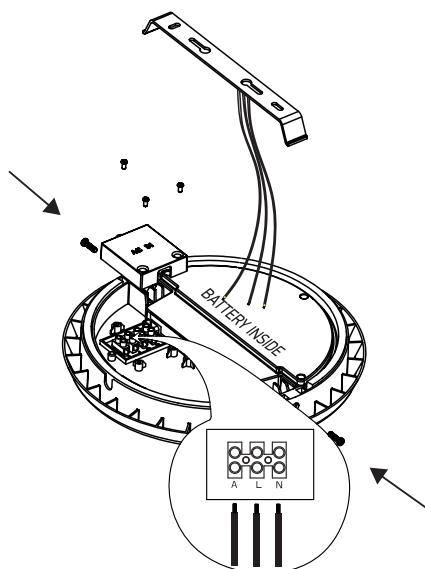

C



-  A = Red - Unswitched Live for emergency only
-  L = Brown - Switched Live
-  N = Blue - Neutral

D

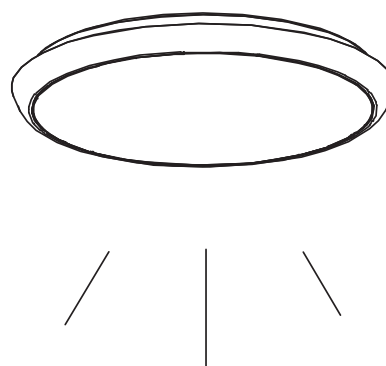

Warnings:

1. Make sure that the product is installed properly before connecting to electricity.
2. Do not cover the fitting.
3. Maintenance and installation should only be carried out by a professional electrician.