

# INSTALLATION MANUAL

67366

**LED**  
BUILT IN



230V | SMD LED | 12W | IP54 | PC  
Complete with 160mA driver.

**80**  
CRI

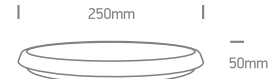

**one**  
LIGHT

**A**

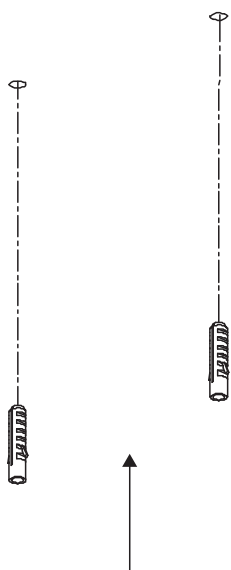

**B**

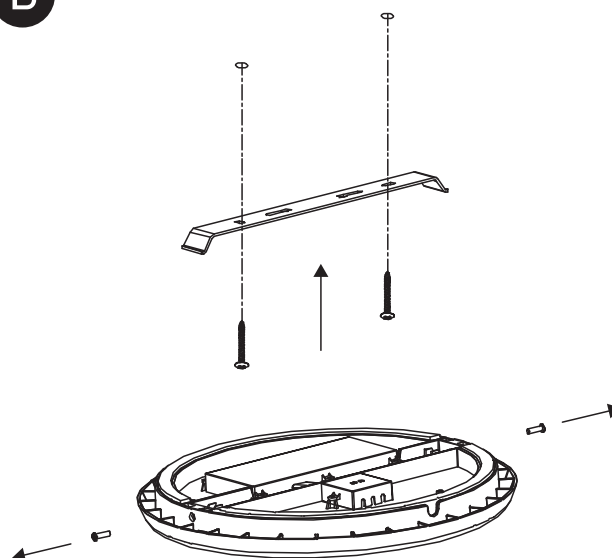

**C**

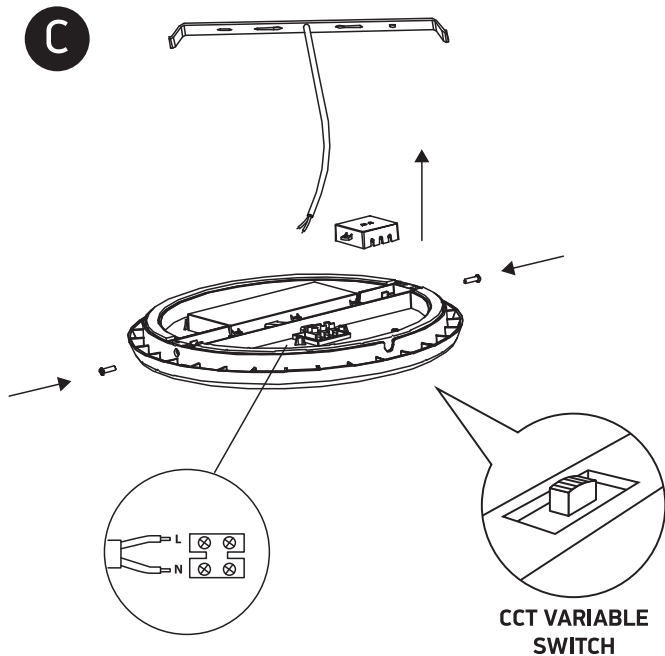

**D**

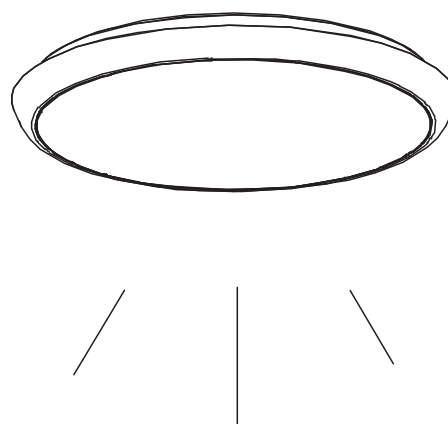

## Warnings:

1. Make sure that the product is installed properly before connecting to electricity.
2. Do not cover the fitting.
3. Maintenance and installation should only be carried out by a professional electrician.

[www.1-light.eu](http://www.1-light.eu)