

# INSTALLATION MANUAL

67370

**ecolight**



230V | SMD 2835 | 25W | IP54 | PC  
Complete with 300mA driver.

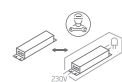

80  
CRI



**one**  
LIGHT

**A**

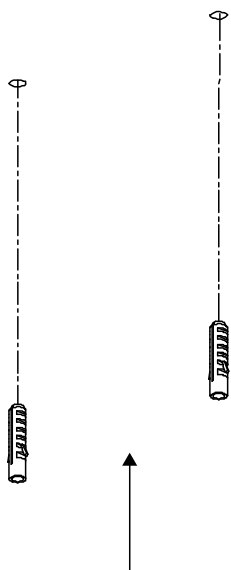

**B**

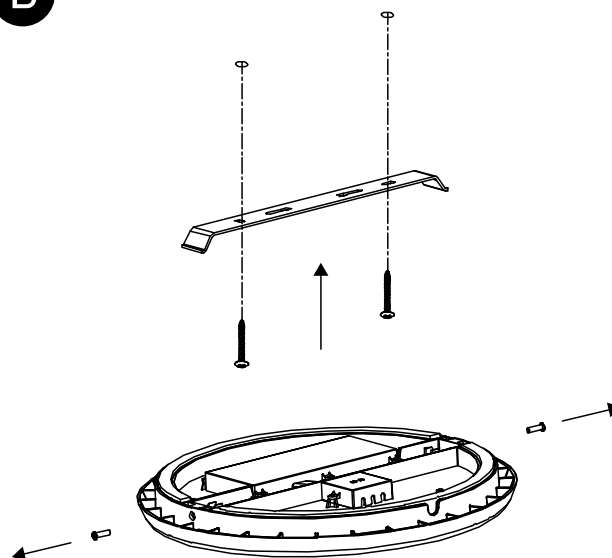

**C**

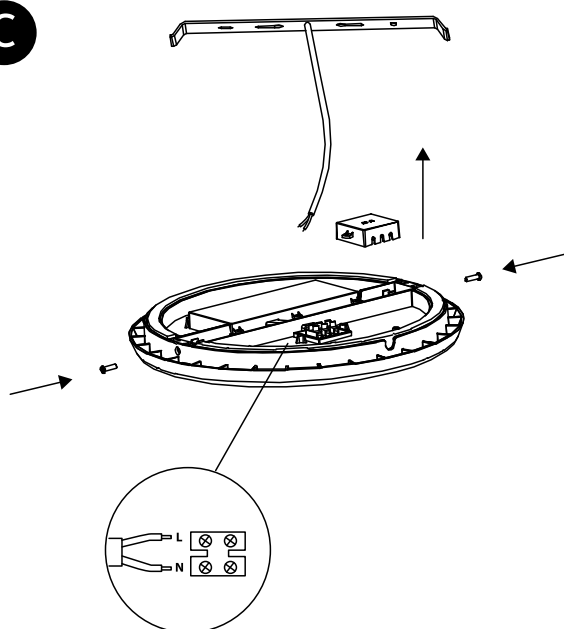

**D**

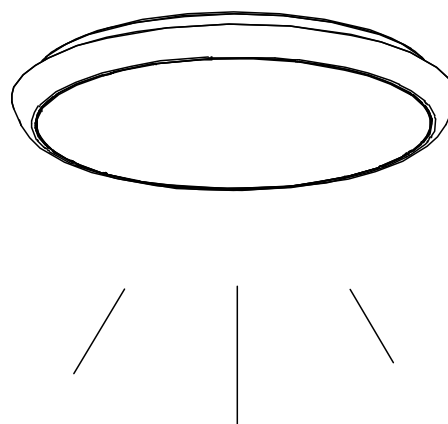

## Warnings:

1. Make sure that the product is installed properly before connecting to electricity.
2. Do not cover the fitting.
3. Maintenance and installation should only be carried out by a professional electrician.