

# INSTALLATION MANUAL

67370

LED  
BUILT IN



230V | SMD LED | 25W | IP54 | PC  
Complete with 300mA driver.

80  
CRI

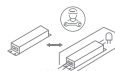

one  
LIGHT

A

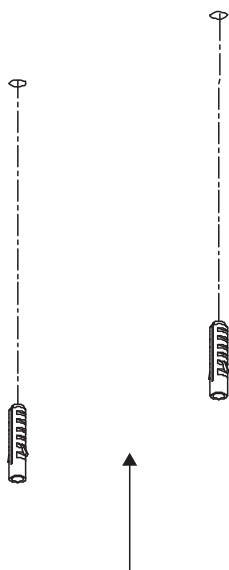

B

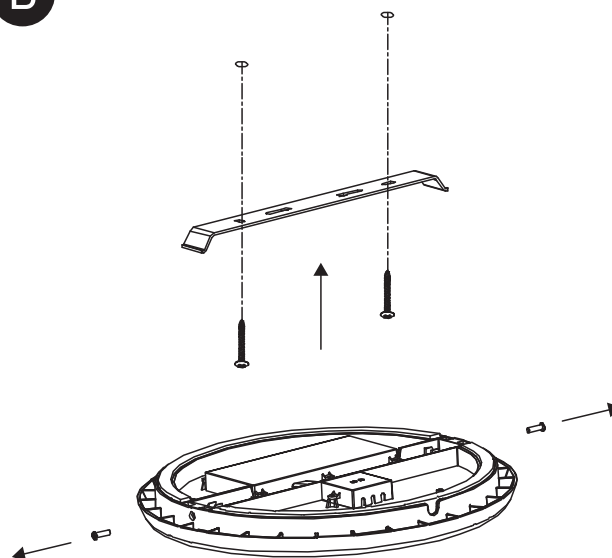

C

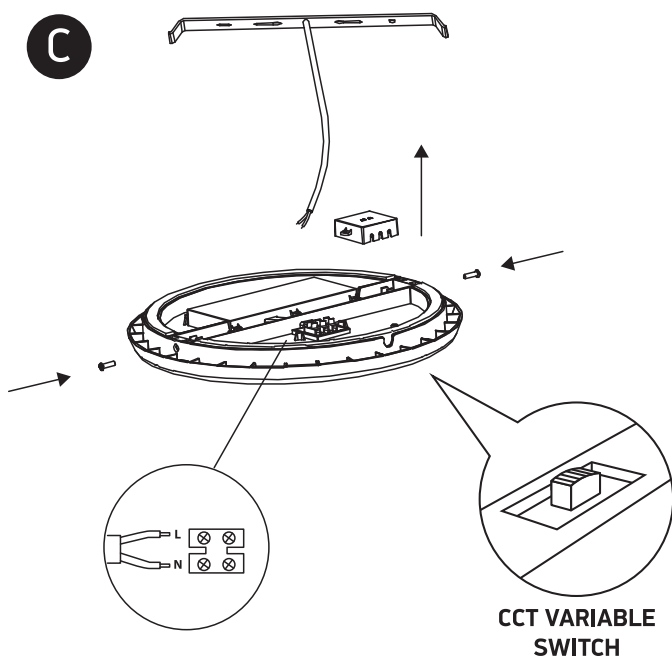

D

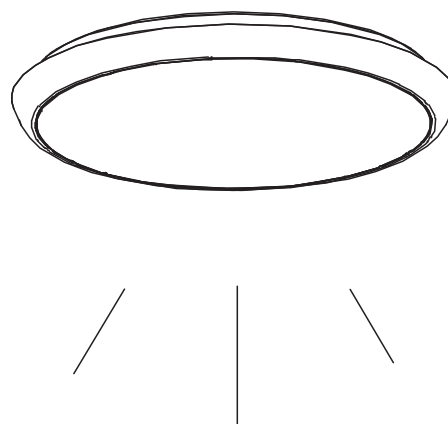

## Warnings:

1. Make sure that the product is installed properly before connecting to electricity.
2. Do not cover the fitting.
3. Maintenance and installation should only be carried out by a professional electrician.

[www.1-light.eu](http://www.1-light.eu)