

INSTALLATION MANUAL

67392/V

LED
BUILT IN



CCT V

CE

EAC

UK

RoHS
COMPLIANT



230V | SMD LED | 7W | IP65 | ABS + PC
Complete with 500mA driver.

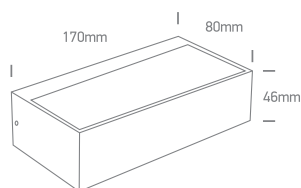
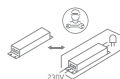

one
LIGHT

A

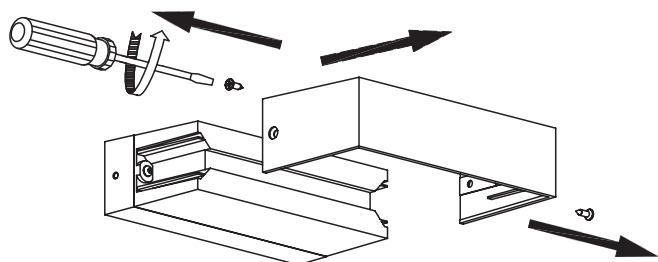

B

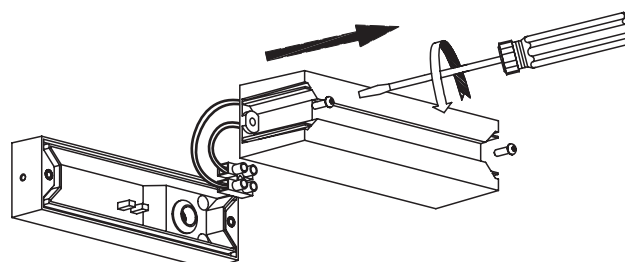

C

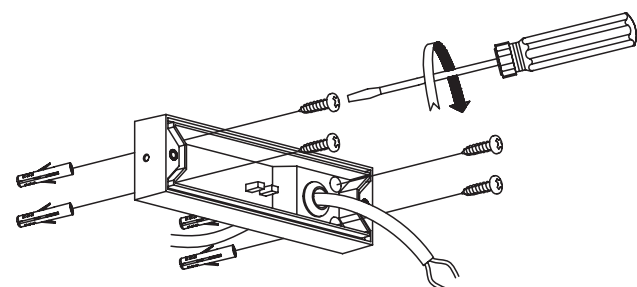

D

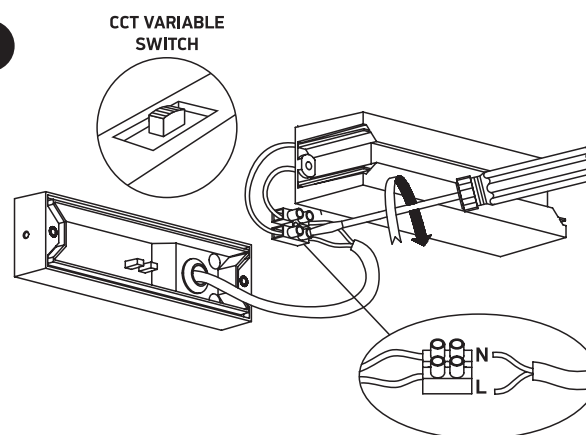

E

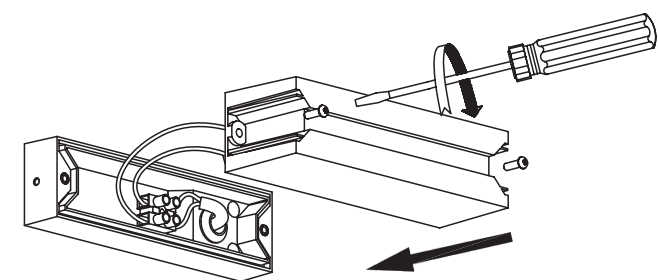

F

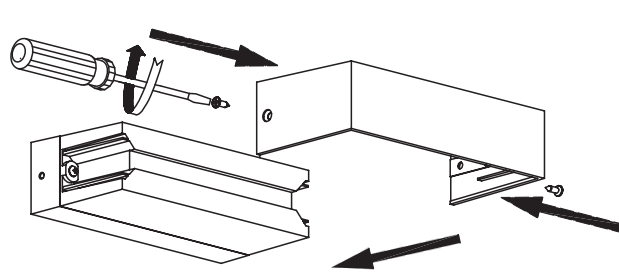

Warnings:

1. Make sure that the product is installed properly before connecting to electricity.
2. Do not cover the fitting.
3. Maintenance and installation should only be carried out by a professional electrician.