

INSTALLATION MANUAL

68068

ecolight



DARK LIGHT

80 CRI

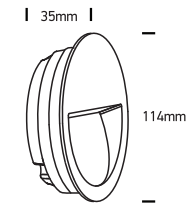

100-240V | SMD 2835 | 3W | IP65 | Die cast

Complete with 350mA driver.
Supplied with box for concrete installation.

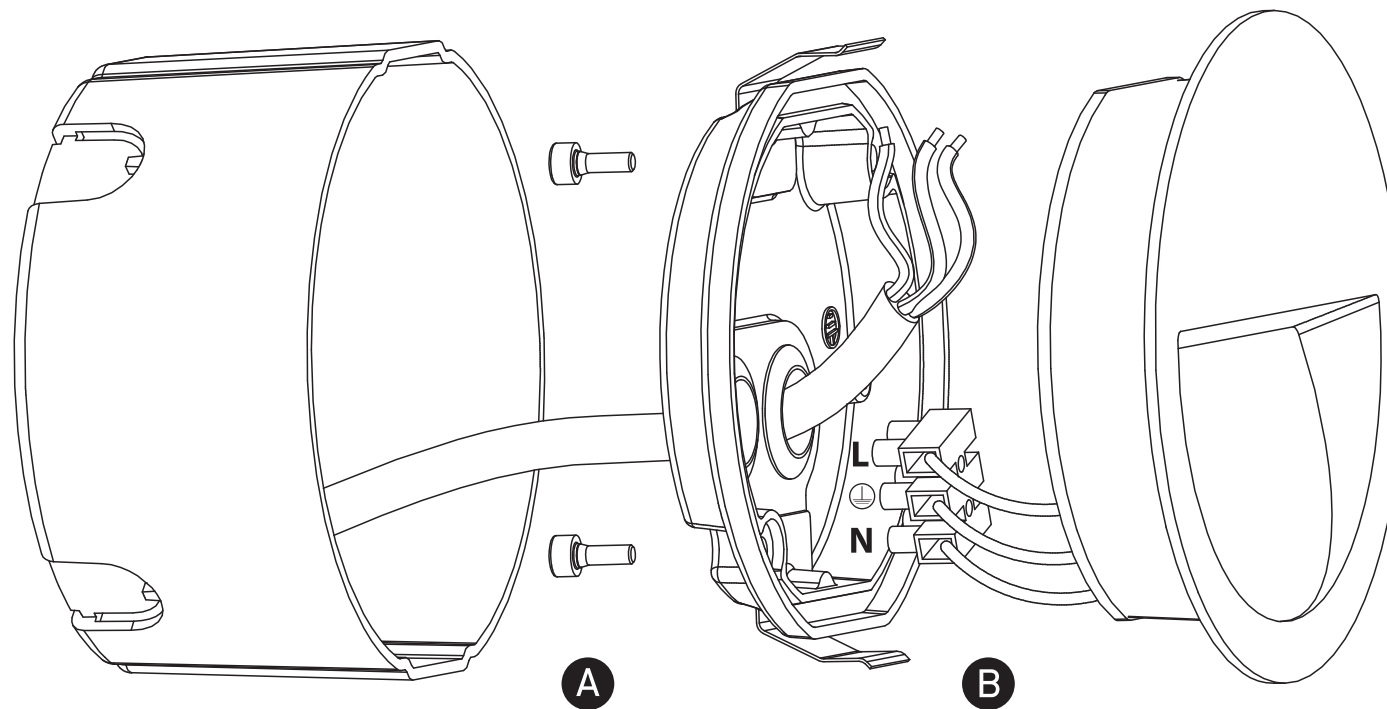
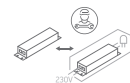

Warnings:

1. Make sure that the product is installed properly before connecting to electricity.
2. Do not cover the fitting.
3. Maintenance and installation should only be carried out by a professional electrician.