

INSTALLATION MANUAL

69042A, 69042B

ecinground

III, DIMMABLE, IK08, CE, RoHS, DIMMABLE, 90 CRI

1W | 350mA | IP67
Natural aluminium
Requires 350mA driver.

Decking Installation: 30mm, 80mm

Concrete Installation: 35mm, 95mm+300mm drainage

200cm

37mm, 37mm, 60mm, 60mm



CONCRETE INSTALLATION

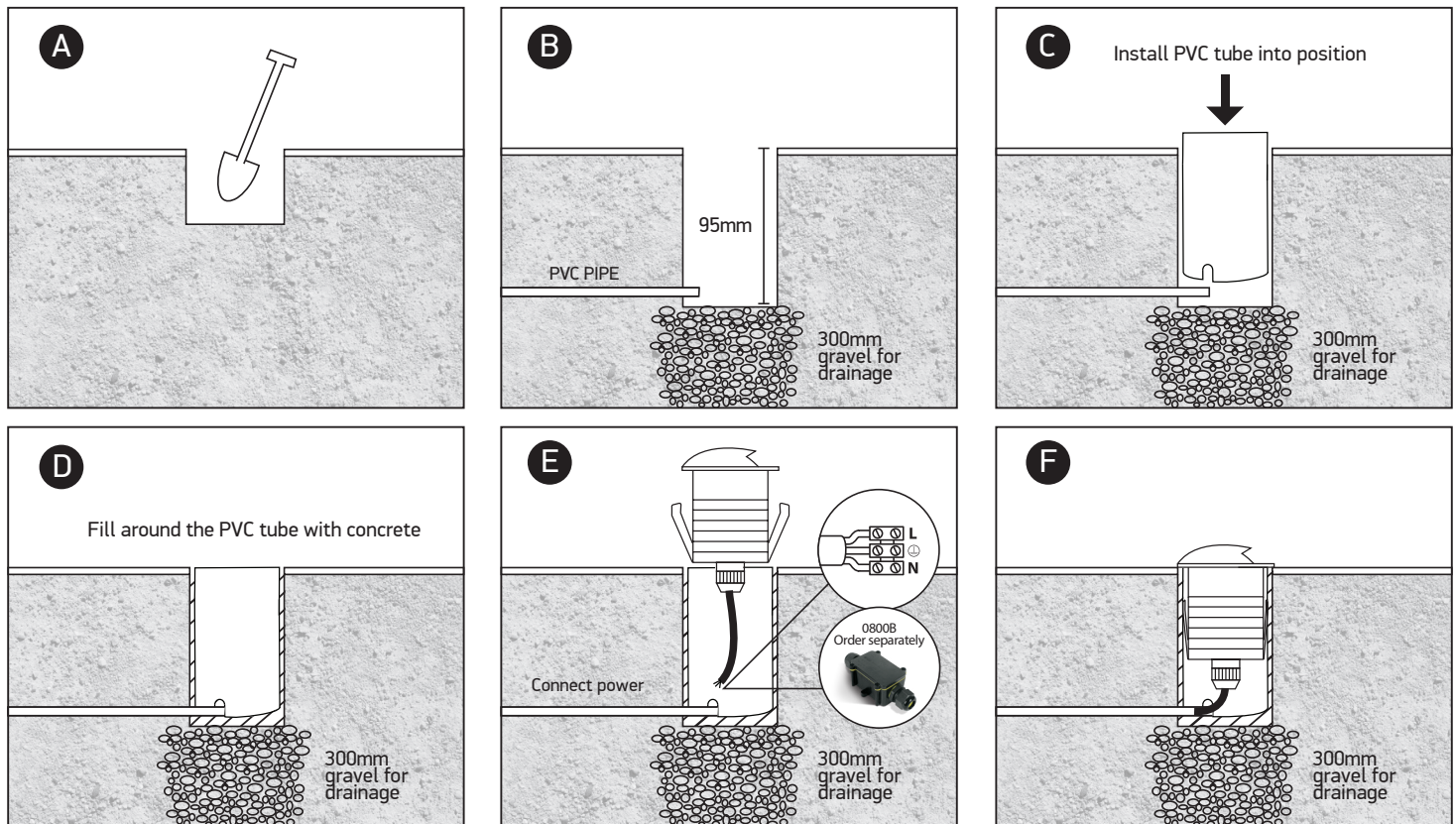

DECKING INSTALLATION

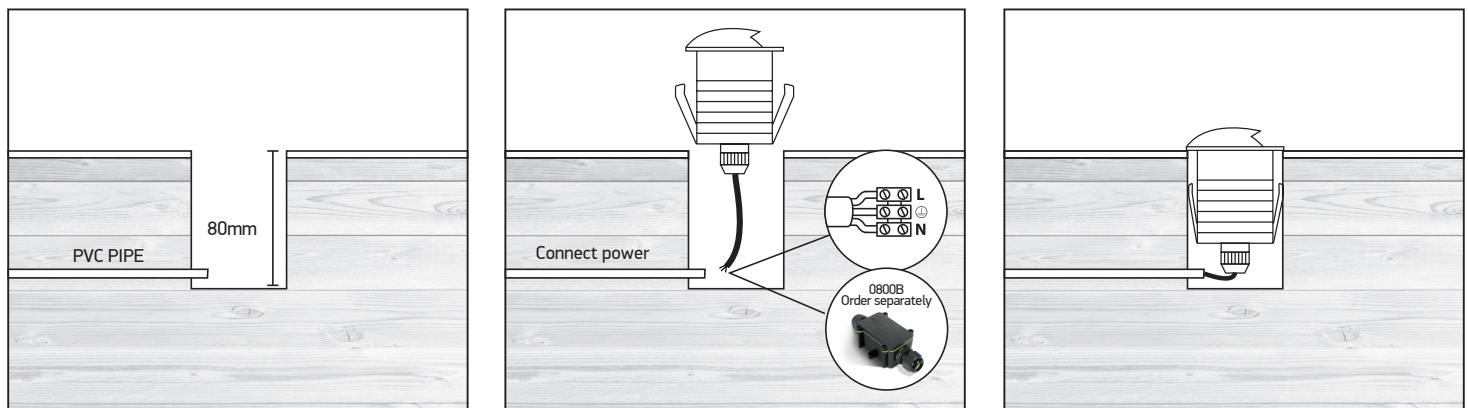

Warnings:

1. Make sure that the product is installed properly before connecting to electricity.
2. Do not cover the fitting.
3. Maintenance and installation should only be carried out by a professional electrician.