

# INSTALLATION MANUAL

## 69076B

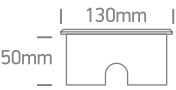

24V DC | COB | 6x1W | IP67  
Stainless steel 316L + Die cast aluminium body  
Requires 24V DC driver.  
Supplied with box for concrete installation.

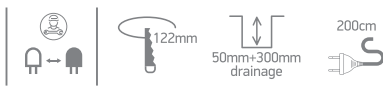

one  
LIGHT

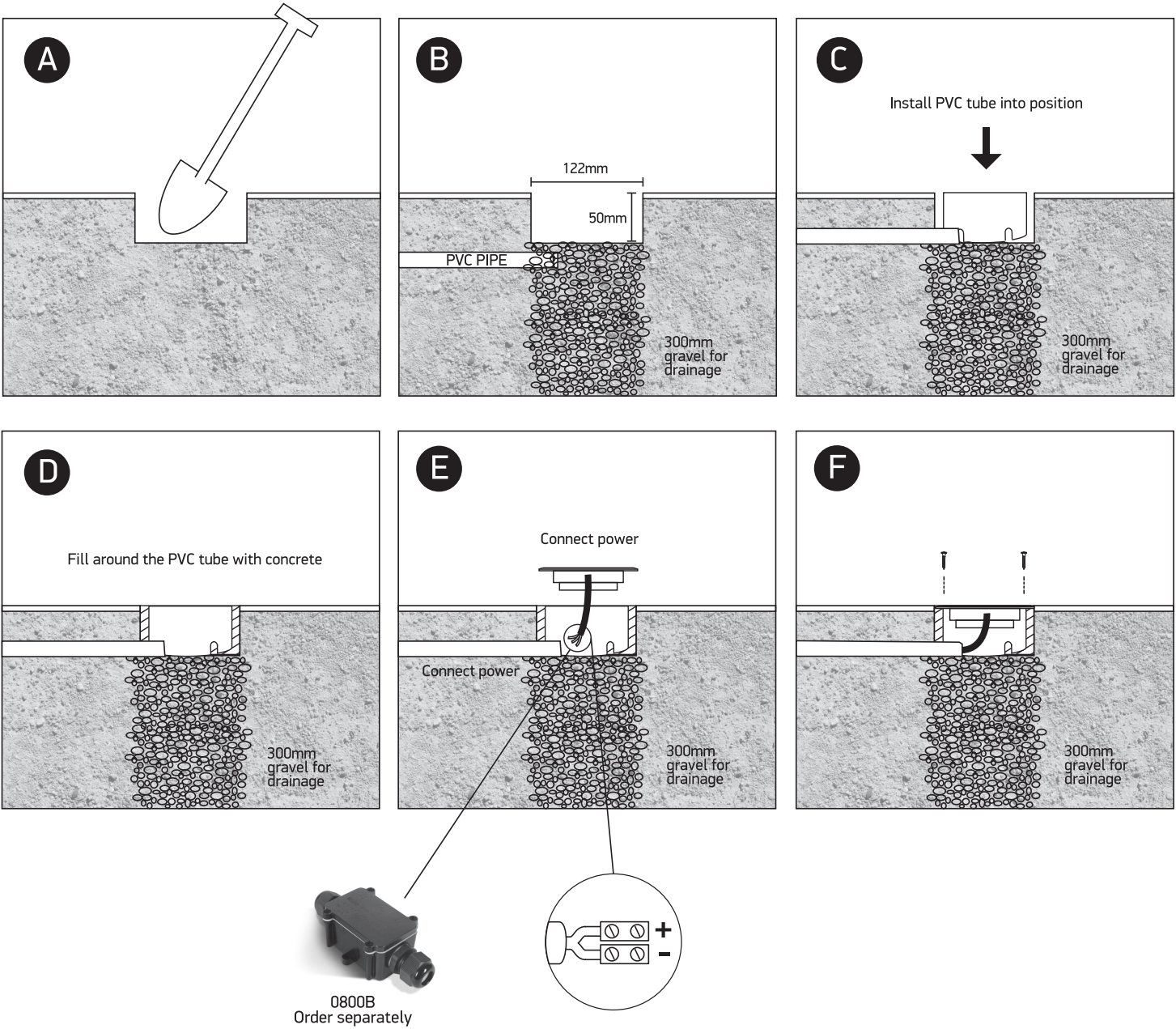

### Warnings:

1. Make sure that the product is installed properly before connecting to electricity.
2. Do not cover the fitting.
3. Maintenance and installation should only be carried out by a professional electrician.