

# INSTALLATION MANUAL

7056A/V

LED  
BUILT IN



CE

EAC

UK  
CA

RoHS  
COMPLIANT



230V | SMD LED | CCT V | 50W | IP65 | Die cast  
Complete with 1200mA driver.

80  
CRI

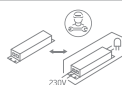

260mm



115mm



300mm

one  
LIGHT

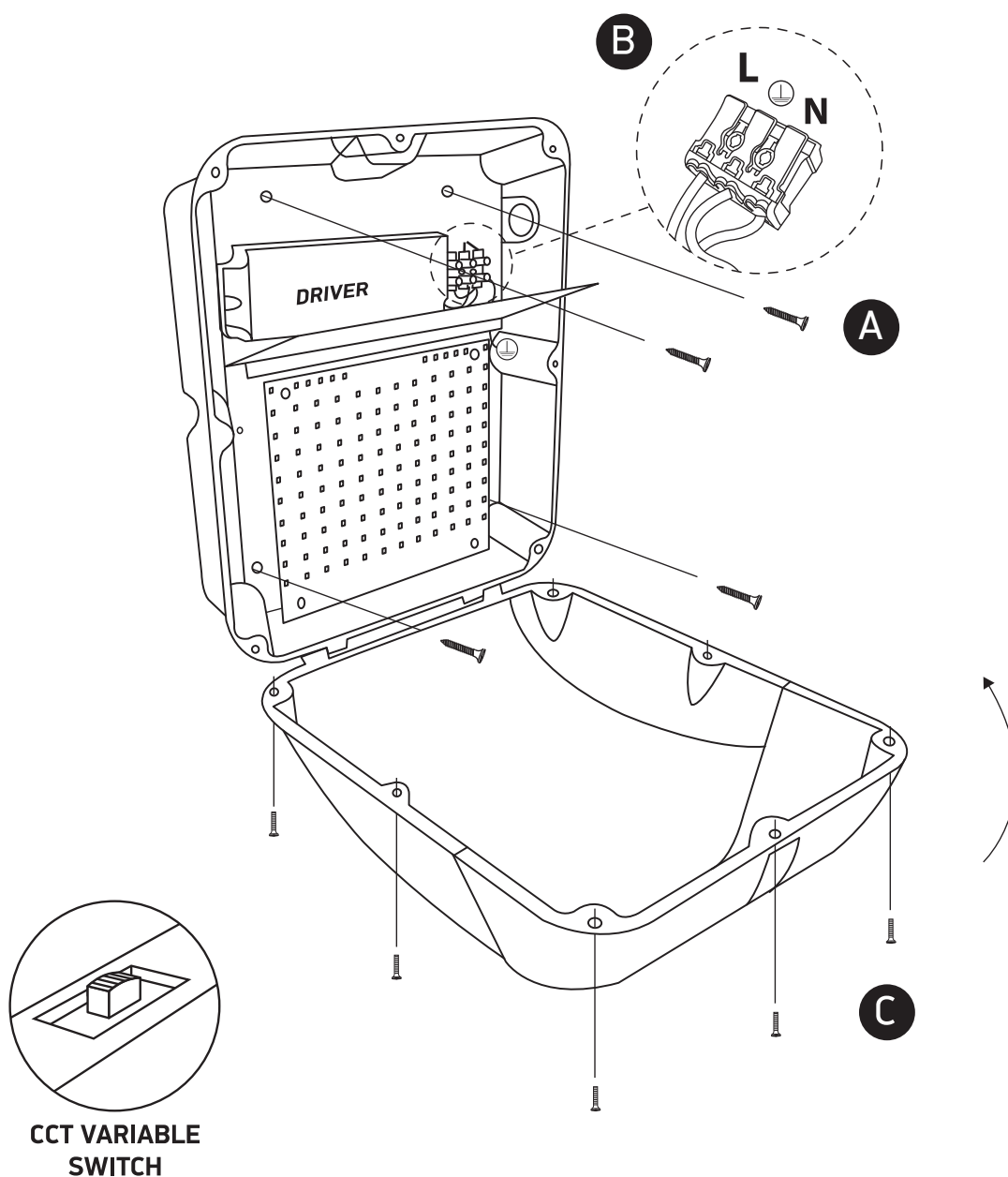

CCT VARIABLE  
SWITCH

## Warnings:

1. Make sure that the product is installed properly before connecting to electricity.
2. Do not cover the fitting.
3. Maintenance and installation should only be carried out by a professional electrician.

[www.1-light.eu](http://www.1-light.eu)