

# INSTALLATION MANUAL

7820

ecostrip



80 CRI



24V DC | SMD 3528 | 60LEDs/m | 4,8W/m | IP20

Requires 24V DC driver.  
Supplied in 5m roll with  
double face adhesive tape.

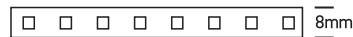

## A. CUT:

The LED strip can be cut every 10cm (6-LED segment) at the clearly marked positions. Cut carefully at the desired length by using a sharp pair of scissors.

## B. CONNECT:

- Use 7824 power supply cable to connect the LED strip to the LED driver's output. Ensure that the polarity is correct (red "+", black "-").
- Connect two pieces of LED strip by using the 7822 connector.

## C. INSTALLATION:

Remove the 3M double face adhesive tape from the LED strip gradually during installation and fix into the required position.

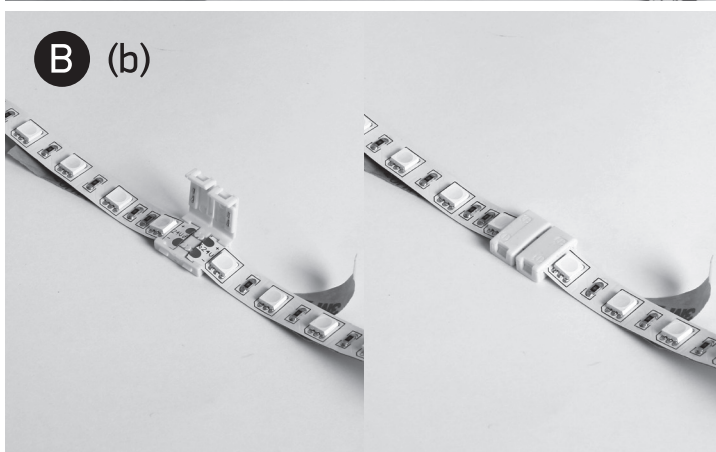
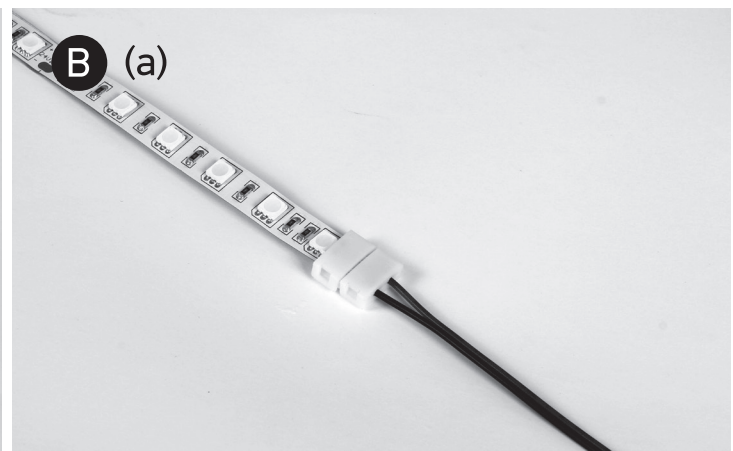
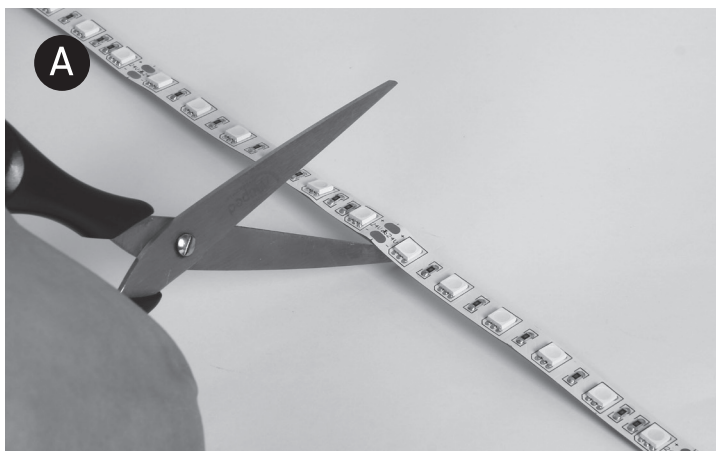

## Warnings:

- The mounting surface must be clean, dry and free from dust or grease.
- Make sure that the product is installed properly before connecting to electricity.
- Do not bend, fold or twist the LED strip.
- Do not bend to install in corners.
- Do not put excessive pressure on surface of LED strip.
- Do not cover LED strip with any materials.
- Do not install in ambient temperatures below  $-10^{\circ}\text{C}$  or exceeding  $45^{\circ}\text{C}$ .
- Always handle the LED strip with care.
- The LED strip should not be exposed to direct sunlight.
- LED strips with different batch numbers may have slight variations in colour consistency ( $\text{CCT} \pm 150\text{K}$ ).
- Maintenance and installation should only be carried out by a professional electrician.