

INSTALLATION MANUAL

7850

ecostrip



80 CRI



230V | SMD 2835 | 60LEDs/m | 6W/m | IP65 | PVC

Requires 7850P power supply.
7850 Supplied in 100m roll.
Cut every 1m.

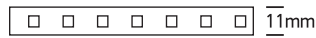
 11mm

one
LIGHT

A. CUT:

- The LED strip can be cut every 1m at the clearly marked positions. Cut carefully at the desired length by using a sharp pair of scissors.
- To seal the non-powered end of the LED strip, use the 7850E end cap. Fill the end cap with silicon glue and carefully place the filled cup on the end of the LED strip.

B. CONNECT:

- Install the 2-pin male connector to the LED strip and connect it to the 7850P power supply. Plug the power supply into the AC outlet.
- To connect two LED strips together use the 7850C connector.

C. INSTALLATION:

Use the 7850F mounting clips to secure the LED strip into the required position.

***When the LED strip is installed outdoor, make sure the power supply 7850P is installed inside a waterproof box.**

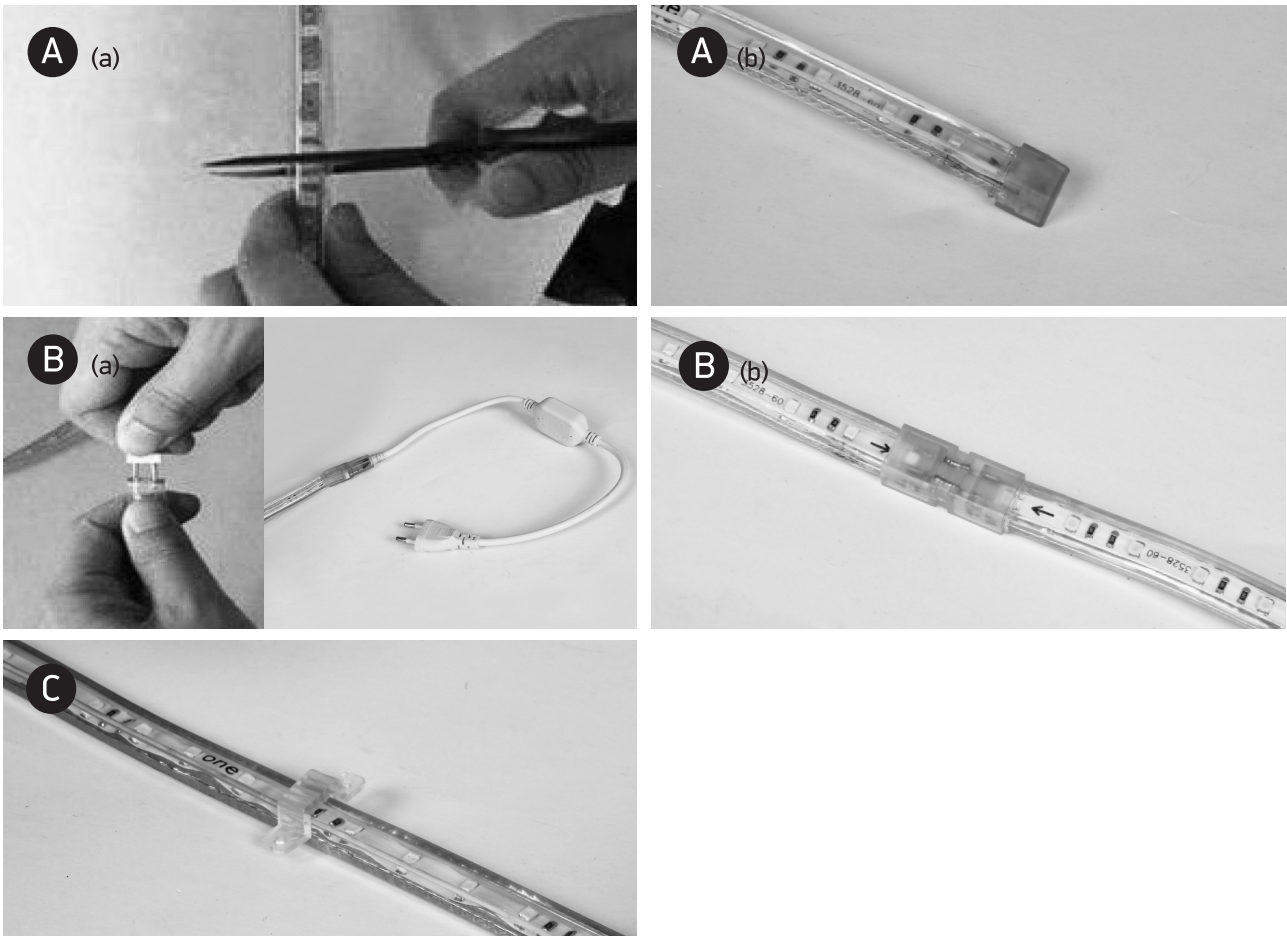

Warnings:

- The mounting surface must be clean, dry and free from dust or grease.
- Make sure that the product is installed properly before connecting to electricity.
- Do not bend, fold or twist the LED strip.
- Do not bend to install in corners.
- Do not put excessive pressure on surface of LED strip.
- Do not cover LED strip with any materials.
- Do not install in ambient temperatures below -10°C or exceeding 45°C.
- Always handle the LED strip with care.
- The LED strip should not be exposed to direct sunlight.
- LED strips with different batch numbers may have slight variations in colour consistency (CCT±150K).
- Maintenance and installation should only be carried out by a professional electrician.