

INSTALLATION MANUAL

7860

ecostrip



80
CRI



230V | SMD 5730 | 60LEDs/m | 9W/m | IP65 | PVC

Requires 7860P power supply.
Supplied in 50m roll.
Cut every 1m.

16mm

one
LIGHT

A. CUT:

- The LED strip can be cut every 1m at the clearly marked positions. Cut carefully at the desired length by using a sharp pair of scissors.
- To seal the non-powered end of the LED strip, use the 7860E end cap. Fill the end cap with silicon glue and carefully place the filled cup on the end of the LED strip.

B. CONNECT:

- Install the 2-pin male connector to the LED strip and connect it to the 7860P power supply. Plug the power supply into the AC outlet.
- To connect two LED strips together use the 7860C connector.

C. INSTALLATION:

Use the 7860F mounting clips to secure the LED strip into the required position.

***When the LED strip is installed outdoor, make sure the power supply 7860P is installed inside a waterproof box.**

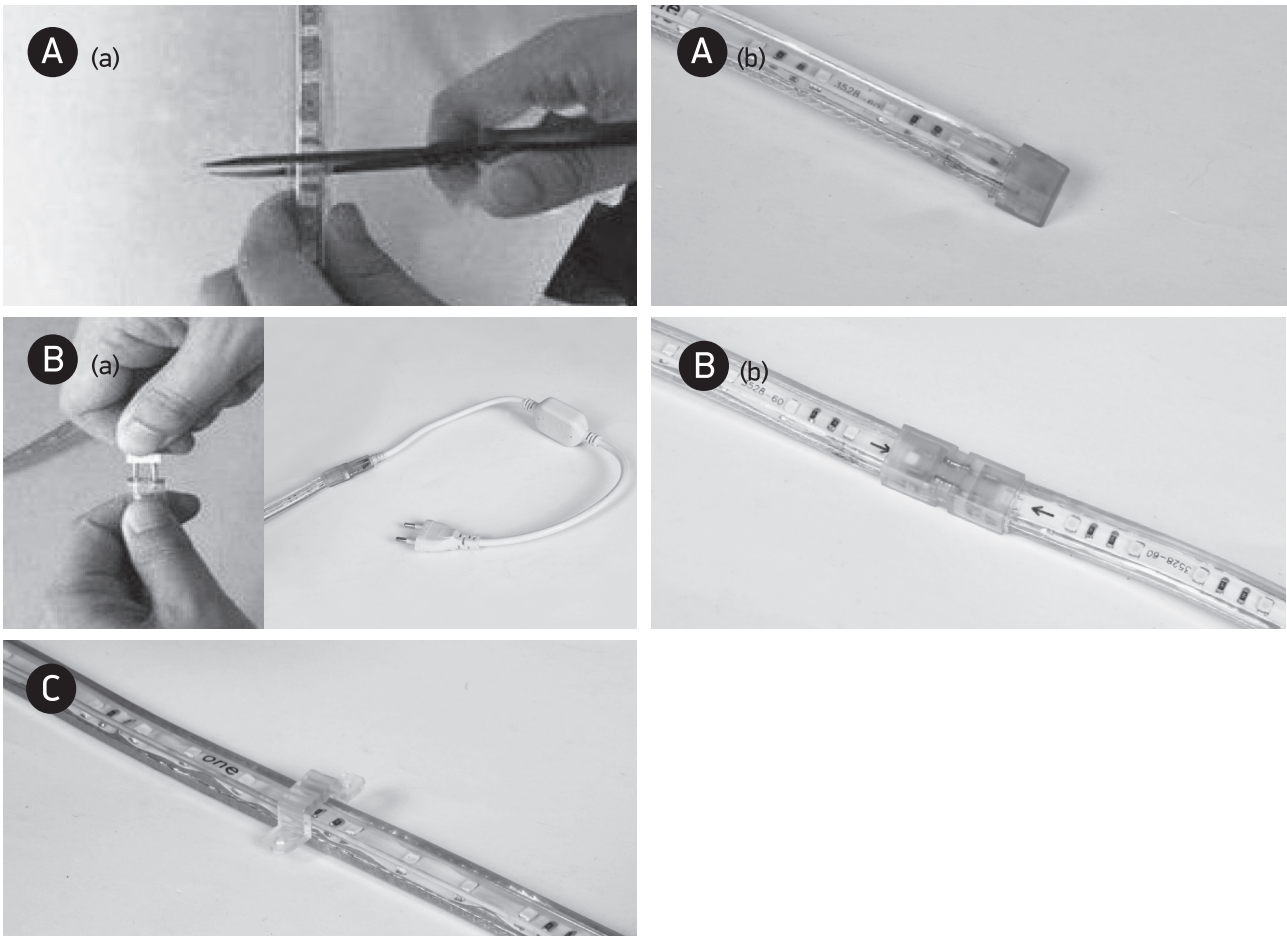

Warnings:

- The mounting surface must be clean, dry and free from dust or grease.
- Make sure that the product is installed properly before connecting to electricity.
- Do not bend, fold or twist the LED strip.
- Do not bend to install in corners.
- Do not put excessive pressure on surface of LED strip.
- Do not cover LED strip with any materials.
- Do not install in ambient temperatures below -10°C or exceeding 45°C.
- Always handle the LED strip with care.
- The LED strip should not be exposed to direct sunlight.
- LED strips with different batch numbers may have slight variations in colour consistency (CCT±150K).
- Maintenance and installation should only be carried out by a professional electrician.